

Walk mini S OWNER'S MANUAL

The product may vary slightly from the picture.

INDEX

Foreword

First and Foremost	04
Declaration	04
Safety Instructions	05
Health Warnings	06

Product Introduction

Product Description	07
KAT Walk mini S Description	07
KAT Walk Special Shoe Covers Description	07
Product Appearance	08
Product Parameters	09
Software description	10

Installation & Preparation

Precautions	11
Unpacking method	12
Tool Preparation	13
List of Items	13

Product Installation and Assembly

Assembly of the Base	14
Assembly of the Back Support	15
Connecting of Wires	18

Software Function Introduction

Content Library	19
Library Manage	21
Controller Dashboard	22
Settings	24
Starting the applications	25
Closing the Application	26
Direction calibration within VR	26

Updating the Mini S Industry Application Software

Updating the Mini S Industry Application Software	27
---	----

First Use Instructions

Sensor Instructions	28
Sensor Initialization	28
Tips for Room Settings of the VR Headset	28
Sensor Calibration	29

Walk mini S Operating Instructions

Walk mini S Quick Operating Instructions -- ONLY 3 Steps to go	30
Walk mini S First Use	31
Stepping On	31
Height Adjustment	32
Harness Wearing	33
Walking Tutorial	34
Accessories Set-up	34
Stepping Off	35

Software Instructions

System Requirements	36
Software Instructions	36

Disassembly and Maintenance

Disassembly Procedure	37
Product Maintenance	37

Appendix

Appendix 1: Optional Accessories List	38
Appendix 2: KAT Control Center	40

Installation of the Cable Management Beam

Product packaging	41
Item List	41
Installation steps	42
Software content	46
Product's maintenance and repairs	46

Frequently Asked Questions (FAQ)

Frequently Asked Questions (FAQ)	47
----------------------------------	----

| First & Foremost

This owner's manual contains all the information you need to install the Walk mini S.

The following symbols are used to indicate crucial information and instructions for the set-up process:



This symbol is a precaution: It usually provides additional information to help with a task, as well as information that applies only to certain situations.



This symbol is a hint, letting you know what might be helpful at that particular point.



This symbol is important: You must complete one or more of the hardware and software installations or settings as described in the manual.



This symbol is a safety warning, to remind you to be wary of your personal safety while performing the task, be mindful of this symbol to avert any potential risks.

| Safety Instructions

To avoid injury or damage to the product, read and follow all the assembly and operation instructions before using the Walk mini S.

- This device is intended for use by healthy people aged 14 to 60 years, of 1.40m (4'7") to 1.95m (6'5") height, and weighing no more than 130kg (285lbs). Do not use the Walk mini S if you do not meet the age, height, or weight requirements, or if your physical condition is not capable of moderate to intense physical activity.

If you are uncertain of your health condition, please consult your doctor first.

- Please use the device according to proper instructions or under the guidance of a professional to avoid damage.

Pregnant women or those with epilepsy, cardiopulmonary diseases, eye diseases, mental illnesses, anemia, and people undergoing postoperative recovery etc. are strictly prohibited from using this device.

- The device contains moving parts. Do not approach during use to avoid accidents, especially for children or pets. Please keep a safe distance of more than one meter.

To avoid damage to the platform or personal harm, please use our special shoe covers, the dedicated shoes and the safety harness according to the instructions. The KAT Shoe covers are to be used with the Walk mini S only and it is forbidden to use them for any other purpose.

- Check the device before use to confirm that it's in a normal state without cracks, scratches, bumps, bends, odd movements or other signs of wear and tear. Check all connections and moving parts to ensure that the nuts, bolts, and other joint structures are securely fastened.

- The base plate is slippery. When getting on/off the device, first ensure that the rotational safety mechanism is locked and firmly hold the supporting rods for more stability.

Make sure the harness is properly worn and fastened during use. Do not use this device without the harness.

Pay attention to the safety under your feet.

Do not take your foot out of the base plate's bounds while in use.

Please pay attention to the gap between the base plate and its frame to avoid safety risks.

- Be sure to read and follow all product instructions and warnings related to your VR headset of choice.

- Choking hazard: Do not leave small components that pose a suffocation hazard to children or pets where they can reach.

- Placement risks: Do not place this device in the following locations:
 - (1)Outdoors with direct sunlight;
 - (2)Inclined or unstable surfaces;
 - (3)Exhibition booths made of glass or those that are incapable of meeting the weight supporting requirements;
 - (4)Near firefighting equipment or safety exits, etc.
- Do not place the device and its other components near fire or heat sources, nor leave it directly exposed to the sun.
- If you need to change location after installation, be sure to disassemble it in strict accordance with the components order, use the same material as the original packaging to wrap the device, and choose a high-quality logistics or handling company, otherwise the product may be prone to damage.
- Keep the device safely away from liquids or containers holding liquids, and keep it dry.
- Do not insert items into any openings of the device.
- Please turn off the power of the relevant equipment before pulling out the plug.
Unplug the device before thunderstorms.
When removing the power cord, be sure to gently pull it out of the plug, and do not pull the cord directly.
- Before connecting the device to the socket, please confirm that the actual socket voltage is compatible. If the voltages of the two do not match, do not connect the device to the power socket.

 If you violate the above safety instructions or carry out other violations, it may cause personal injury or adverse consequences, and KAT VR will not be responsible.

| Health Warnings

The following health warnings are updated regularly to ensure accuracy and relevance:

- Before use, you need to read the product manual carefully and follow the given instructions.
- We do not recommend prolonged use due to possible physical discomforts afterwards.
Symptoms of discomfort may be nausea, dizziness, or headaches. If you feel any discomfort, please stop using it immediately and do not engage in any activities that pose a safety hazard until the symptoms subside.

- During the use of this device by a child, a guardian should always be present to ensure that they do not experience any of the above discomforts. If it's your first time, shorter periods of use are advised. Only when you have adapted to the virtual reality, is it advised to gradually increase the length of use.
- If you feel fatigue, hangover or are under the influence of alcohol or drugs, are emotionally stressed or anxious, experience headaches or an earache; it is strictly forbidden to use the device, otherwise your condition will be aggravated.
- Anyone who has the following symptoms when using the device should stop immediately:
 - (a)Seizures, loss of consciousness;
 - (b)eye fatigue, eye muscle twitching, blurriness or other visual abnormalities;
 - (c)impaired body balance or hand-eye coordination;
 - (d)lethargy, nausea, excessive sweating, or any symptoms indicating to motion sickness.
- Symptoms caused by virtual reality may persist and become more apparent in a few hours. For your personal safety, do not drive, operate machinery, engage in other activities that are visually or physically demanding or require body balance and hand-eye coordination, until full recovery.



Those who use this device are considered to have full capacity of civil conduct and have complied with the aforementioned matters.

| Product Introduction

Product Description

Walk mini S Description

KAT Walk mini S is a second-generation Virtual Reality Treadmill tailored entirely for VR Arcades and industry training applications. Integrating our enhanced natural walking technology with the force of haptic feedback, increased upper-body freedom (additional waist DOF), improved hi-tech appearance and a second-gen Control Center, the mini S offers a deeply immersive and professional Virtual Reality walking experience.

Walk mini S Special Shoe Covers Description

The KAT shoe covers are designed for the sole purpose of use with the Walk mini and Mini S Omni-Directional Treadmills. With use of constant friction, they help to simulate human gait cycle. The concave design of the walking platform works in synergy with the shoe covers to provide a more natural feeling of walking, greatly increasing immersion. Furthermore, the shoe covers serve the purpose of helping you board our device faster, without the need to change your shoes.

Product Appearance

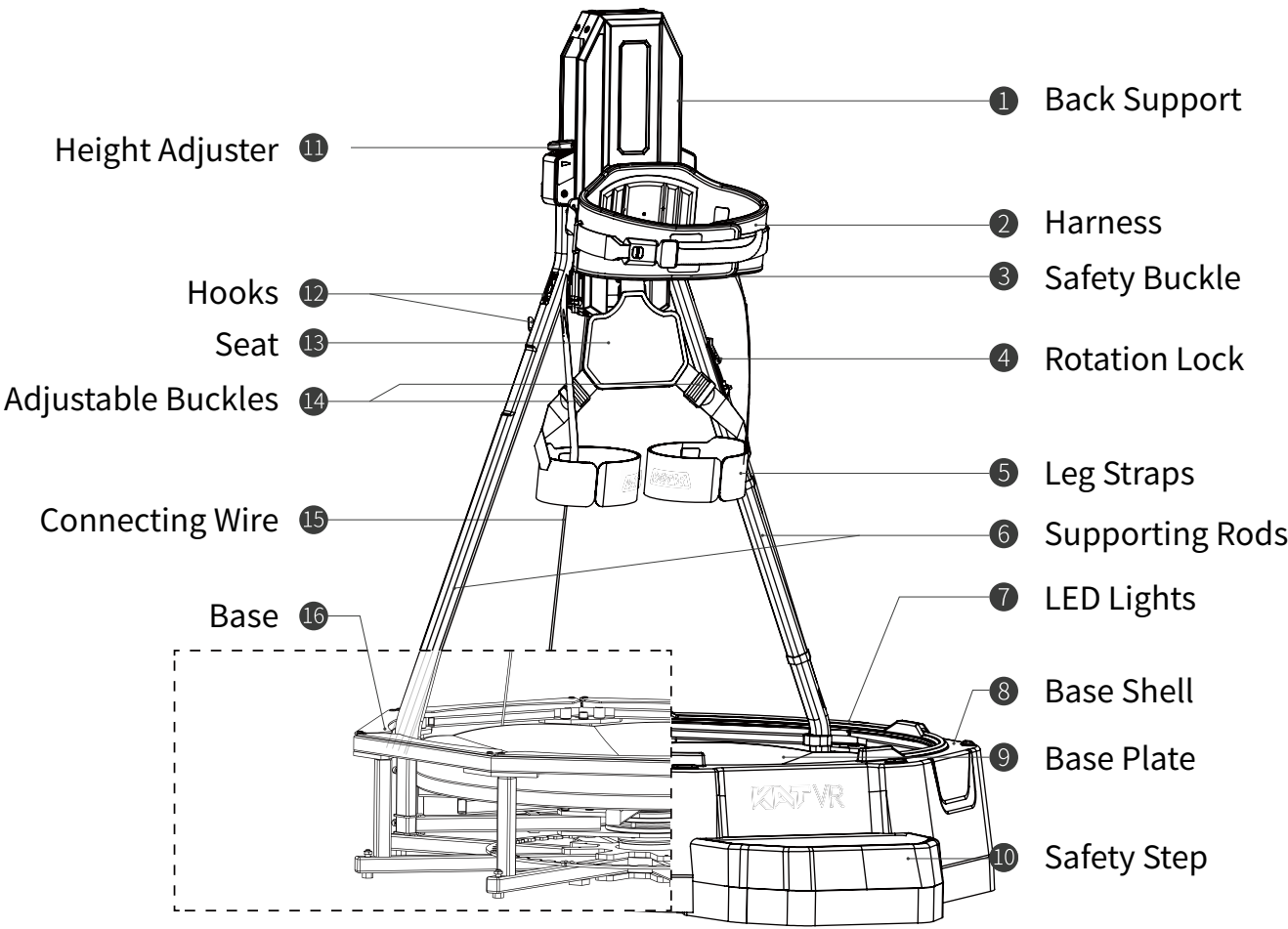

Product Parameters

Suitable age	14-60 years
Suitable weight	130kg and below
Suitable height	1.4m - 1.95m
Product weight	103kg
Range of waist	550mm - 1100mm
Length of leg straps	740mm
Base plate height	280mm
Step height	155mm
Range of Motion	270mm
Product size	1535mm*1170mm*1476mm
Base plate diameter	940mm
Floor space	1.37m ²
Product voltage	100V - 240V
Rated power	50w
Working temperature	0°C - 40°C
Storage temperature	-5°C - 50°C

Software description

 KAT Industry software is a product management tool developed for the Walk mini S users. It lets you easily and efficiently access any content supported by your device, at the same time provides insight into the device operation status as well as control over the adjustable settings. With SteamVR, KAT Industry helps you set the software functions directly from within VR without the need to access a remote computer. The software client provides you access to two primary functions: Content Library and Controller Settings.

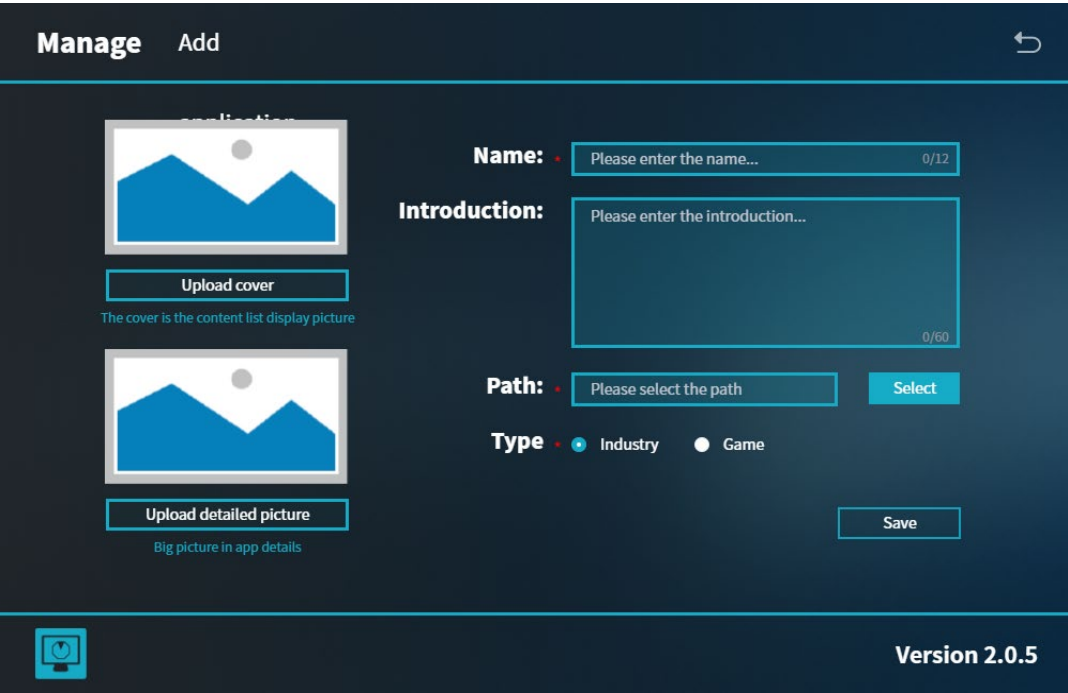

In the controller settings you can monitor the equipment connection status and adjust the settings of customizable functions.

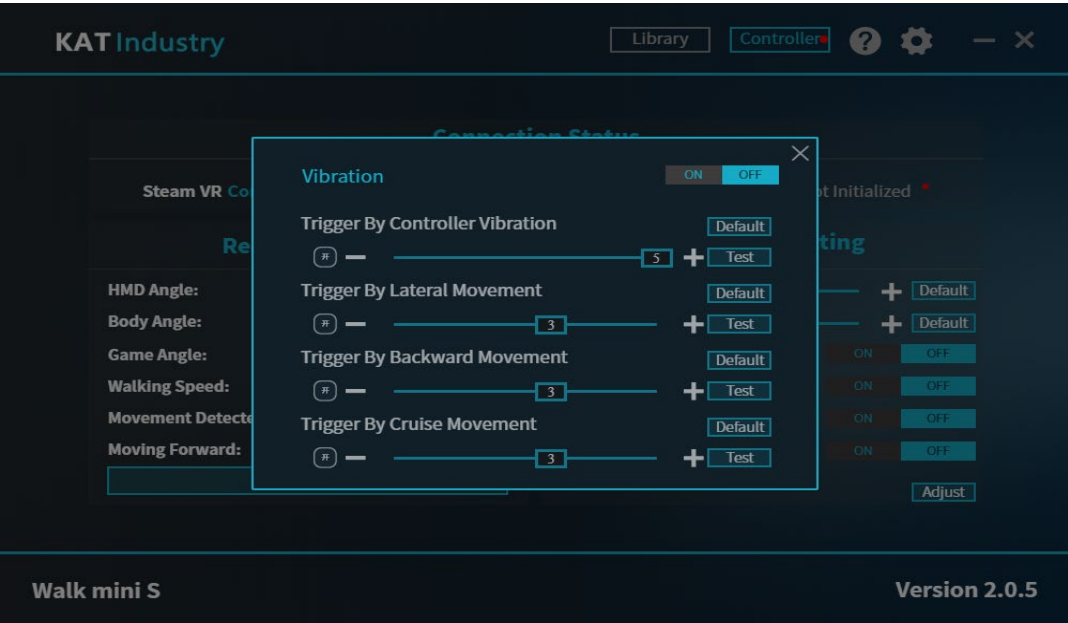

Installation Preparation

Due to possible safety hazards in the installation process, please be cautious. Read the suggestions we've compiled for you carefully before attempting installation.

Precautions

Tool preparation before unboxing

- Before unboxing the Walk mini S, please prepare a pair of scissors, a screwdriver and a claw hammer, wear protective gloves as well as the appropriate footwear for such handiwork, slippers or high-heeled shoes are unsuitable.
- Please note that the gross weight of the package is approximately 163 kg. Please have at least two adults assist with the unboxing to ensure no damage is done to either you or the product.
- Remove any obstructions in the handling process so as not to scratch the walls or the floor.

Placement

- Place the device near a computer so as to ensure that the USB cable is accessible.
- It is not advised to place the device on any easily scratched surfaces, such as wooden or tiled floors.
- Place the device on leveled ground for its stability during operation.
- Ensure there are no objects or household items that can be knocked over within its vicinity.

Unpacking method

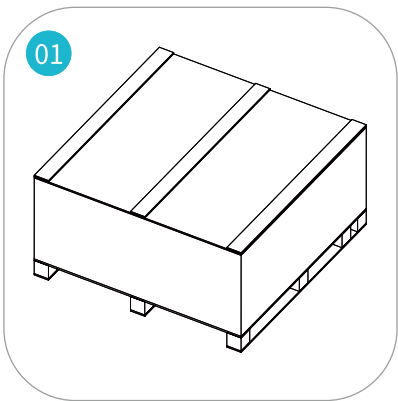

Place the packing box on the floor

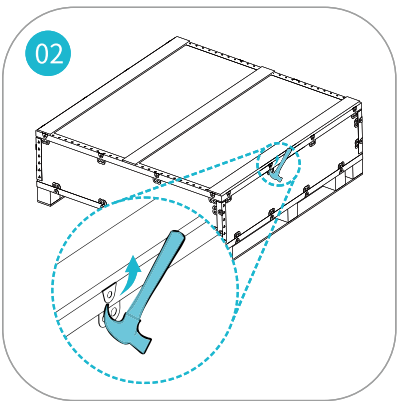

Lay the packing case flat, use a claw hammer to pry open the fastening buckle, and tap until it is facing up

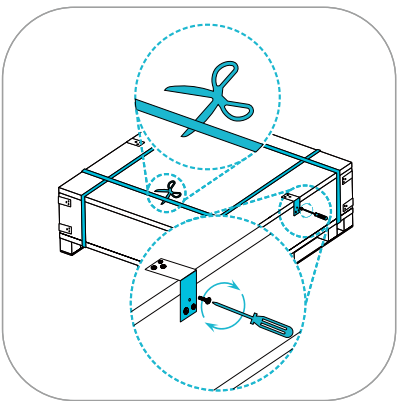

Cut the straps and using a screwdriver remove the screws as shown above (6 in total).

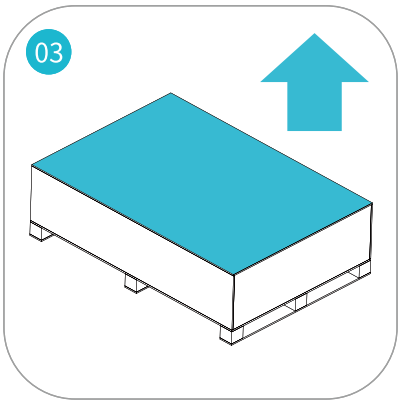

Lift the top of the packing case

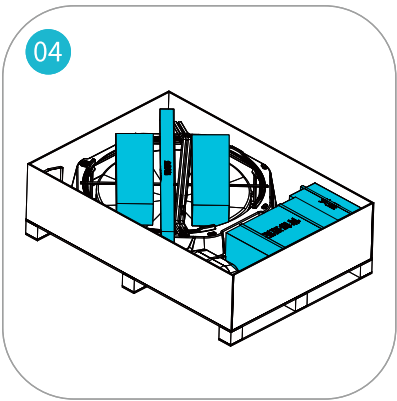

Remove the base, back gear, accessories, etc from the packing case

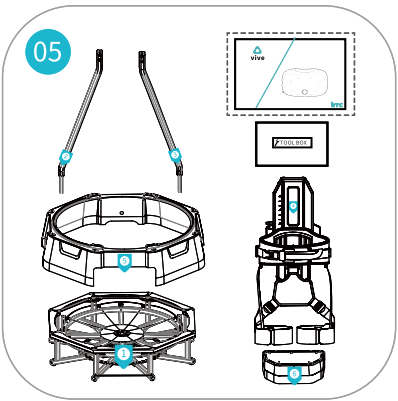

Cut off the straps, check the parts and accessories according to the list of items

Tool Preparation

Please check carefully that the package came with the proper number of each tool or accessory. If any item is missing, please contact customer service (service@katvr.com).

List of Items			
Main Components	Base	1	Including a base shell and a base plate
	Back support	1	
	Supporting rods	1	2 rods on each side
	Safety step	1	
Tools	Allen key/Hex key	1	5mm, 6mm, 1 piece of each
	Open-end wrench	1	17*19mm, 20mm, 1 piece of each
	Phillips screwdriver	1	4 inches
	Level	1	18mm*9mm
Accessories	Walk mini S owner's manual	1	
	Special shoe covers	1	
	Hexagon socket button head Screw M8 X 16	1	For installation
	Hexagon socket button head Screw M8 X 20	1	For installation
	Cross recessed countersunk head Screw M4 x8	1	For installation
	screw M8 X 16 with 8mm gasket	1	For installation
Software	KAT Industry	1	Contact us for more information

| Product Installation and Assembly

Assembly of the Base

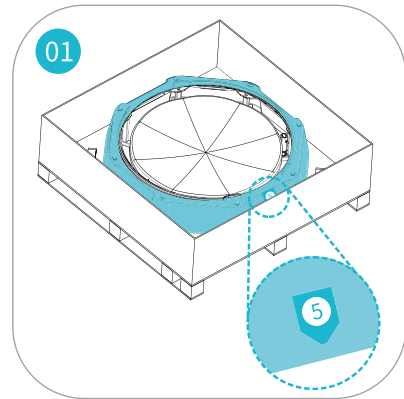

Remove the base frame marked with a sticker "5", and set it aside for assembly.

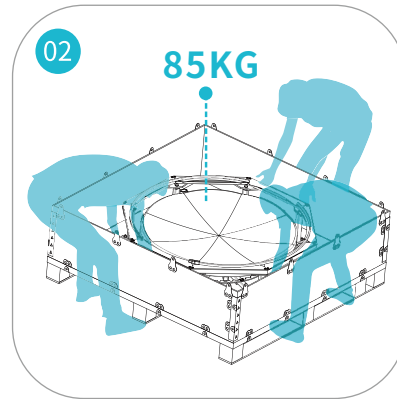

Lift up the base which weighs approximately 85kg and place it on a flat surface at least 60cm away from the wall.

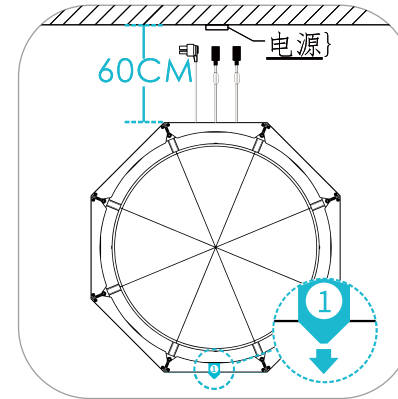

The side with sticker "1" should face forward, as shown in the picture.

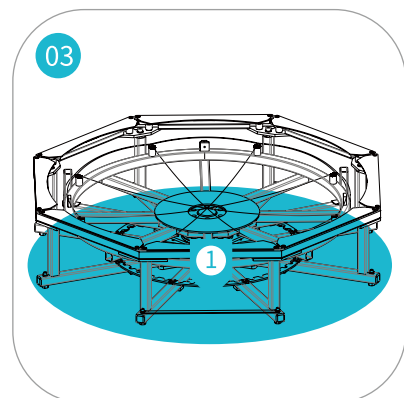

If you need to place the device on easily scratchable surface, insert a mat underneath or use other protective measures to avoid damage to your floor.

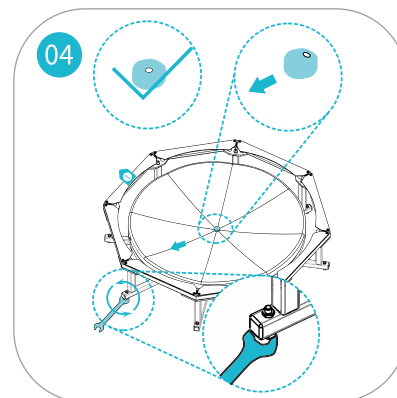

Once the base is set up, place the level in the center; if the bubble inclines to the sides, use the open-end wrench in the toolbox to adjust the foot screws and measure again until the base is perfectly leveled for an optimum experience.

Assembly of the Back Support

Due to necessary quality control testing in the factory, minor scratches may be found on component connections but they will not affect the normal operation of the device.

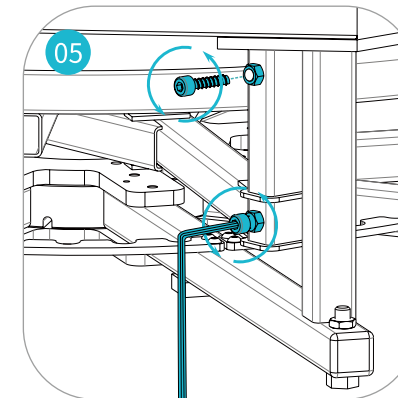

Take out the large hex Key/ allen key from the toolbox and remove the four screws tightened at the base frame' s foot on two sides and put them aside.

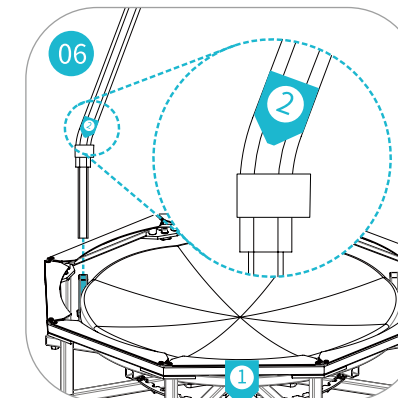

Take out the supporting rod marked with sticker "2" and insert it into the vertical tube on the left side of base with sticker "1".

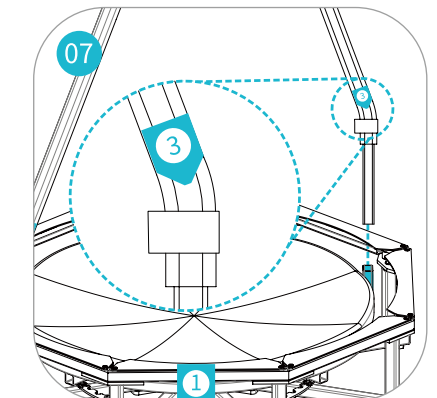

Take out the supporting rod marked with sticker "3" and insert it into the vertical tube on the left side of base with sticker "1".

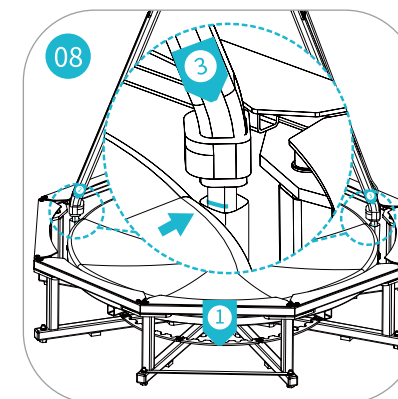

Lift up the hose a little bit so as to insert the supporting rods to the very bottom.

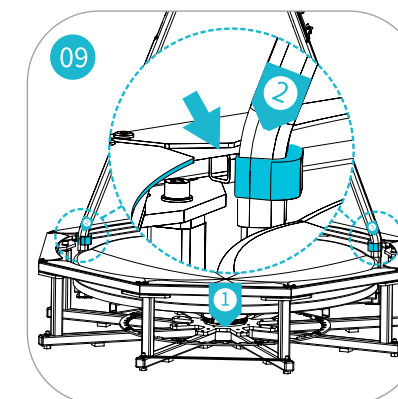

To complete this procedure, you need to make sure that the top of the hose aligns with the surface of the base frame as shown in the picture.

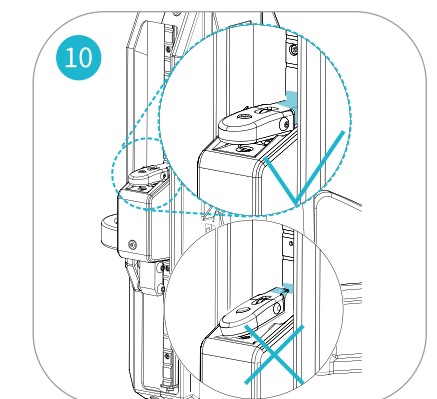

Secure the height adjuster by locking it, in case of accidental falling of back support when installing.

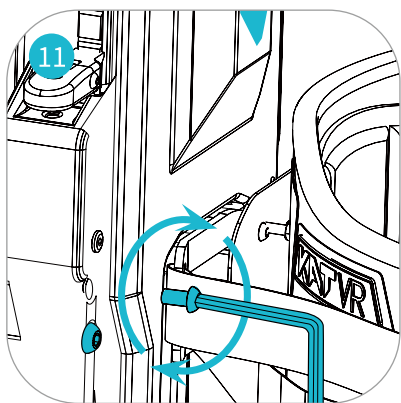

Unscrew the screws from the back support.

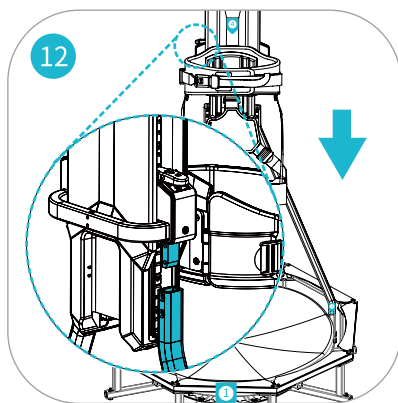

Insert the bolts of the back support to the square holes at the top of supporting rods, and ensure that the stickers "1" and "4" are aligned.

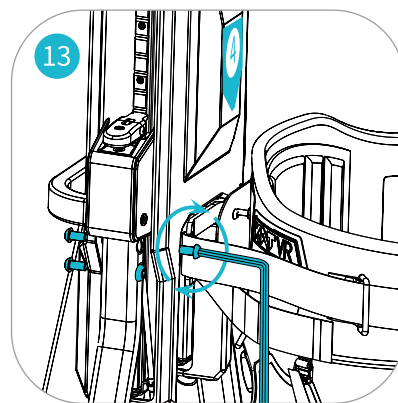

Tighten the screws on each side to the vertical tube at the top of the supporting rods.

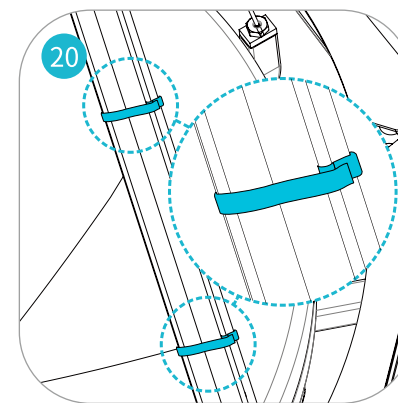

Fasten the supporting rod with the 2 velcro straps on the rotation lock wire.

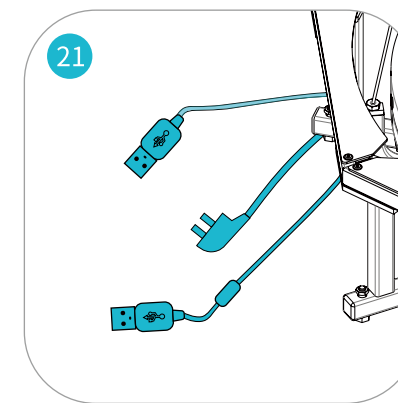

Pull out the triple-end cable with power cord and 2 USB cables. Connect the extension cable to the shorter of the two USB cables.

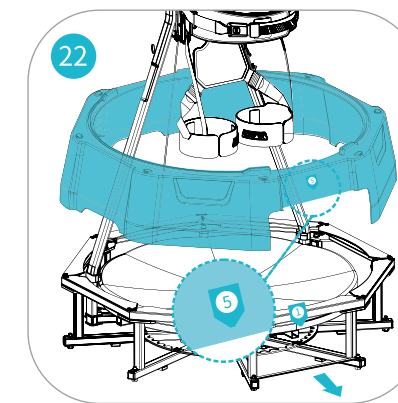

Slowly place the shell with the sticker "5" onto the base, and make sure that stickers "1" and "5" are aligned.

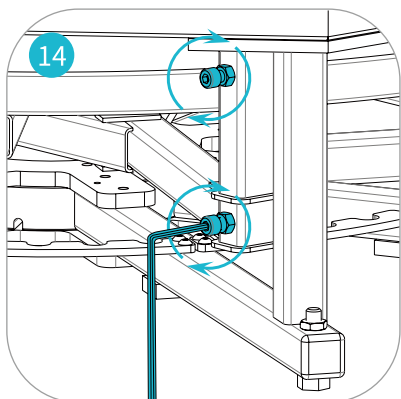

Use the hex key/allen key to tighten the four screws in place on both sides, holding the supporting rods firmly.

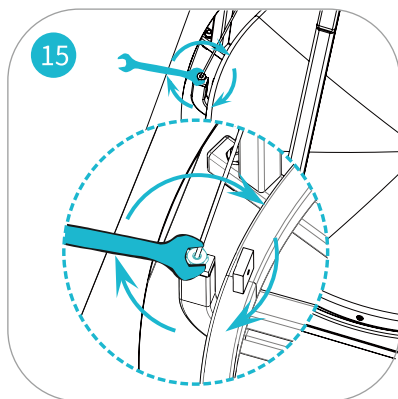

Securely tighten the bolt joining the connecting wire to the base frame.

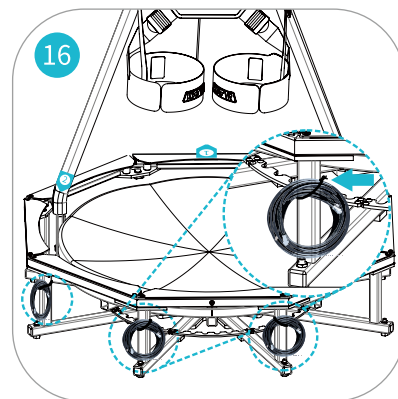

Remove the three cables tied to the base frame and sort out the rotation lock wire.

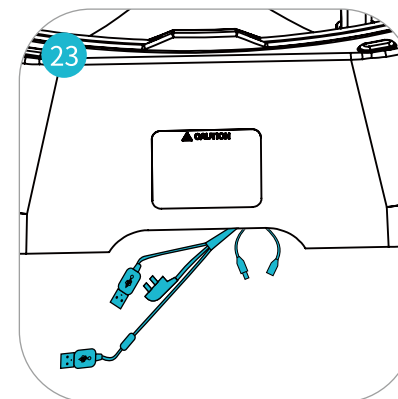

Connect the base housing to the DC plug on the base structure. The exposed two USB cables and three-wire power cables are inserted into the bundle cable tube

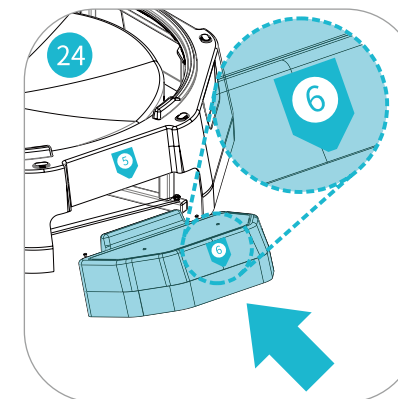

Slide the safety step marked with the sticker "6" into the gap of the base frame.

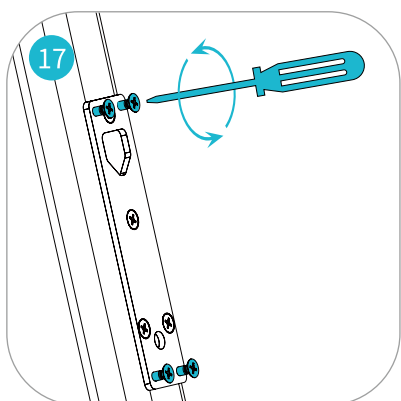

Unscrew the four screws fastened on the plate of the rotation lock and store them for the future use.

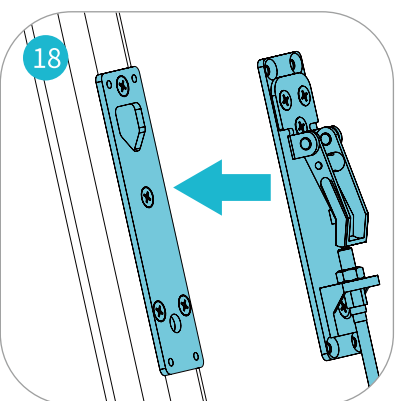

Find the switch of the rotation lock at the base and put it together with the plate on the supporting rod.

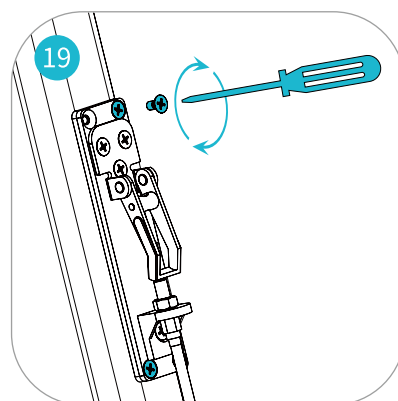

Tighten the four screws removed earlier.

Connecting of Wires

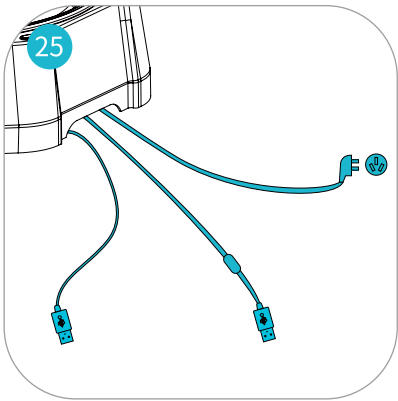

Connect the power cord to a socket and the two USB cables to a PC.

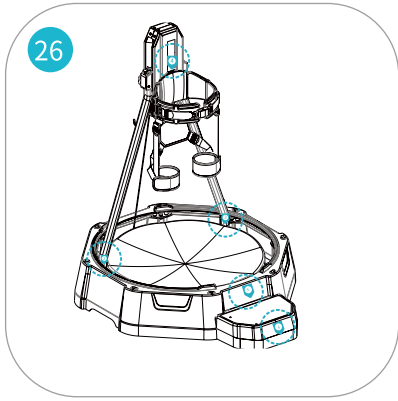

Remove the stickers

Software Function Introduction

Content Library

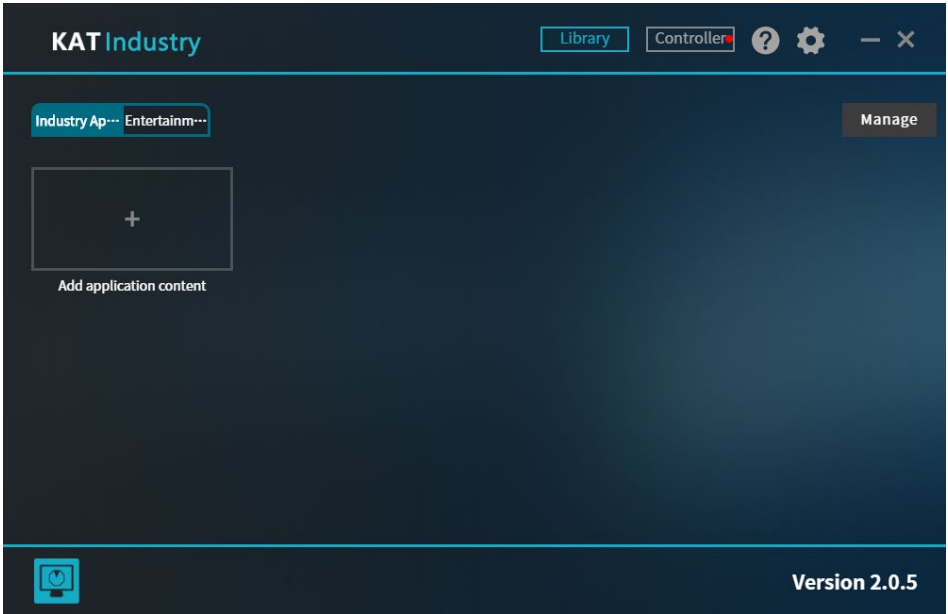

(1)

When you enter the KAT Industry software, the first thing you will see on the homepage is the Content Library (1). The software dashboard allows to easily add your local industry application content and game content into The Content Library to experience them on your Walk Mini S devices.

Method of adding new content:

1)Adding industry applications

First select the classification "Industry Application" in the upper left corner. You will then see a button with a "+" sign. Click it to enter the "Add" page as below (2)

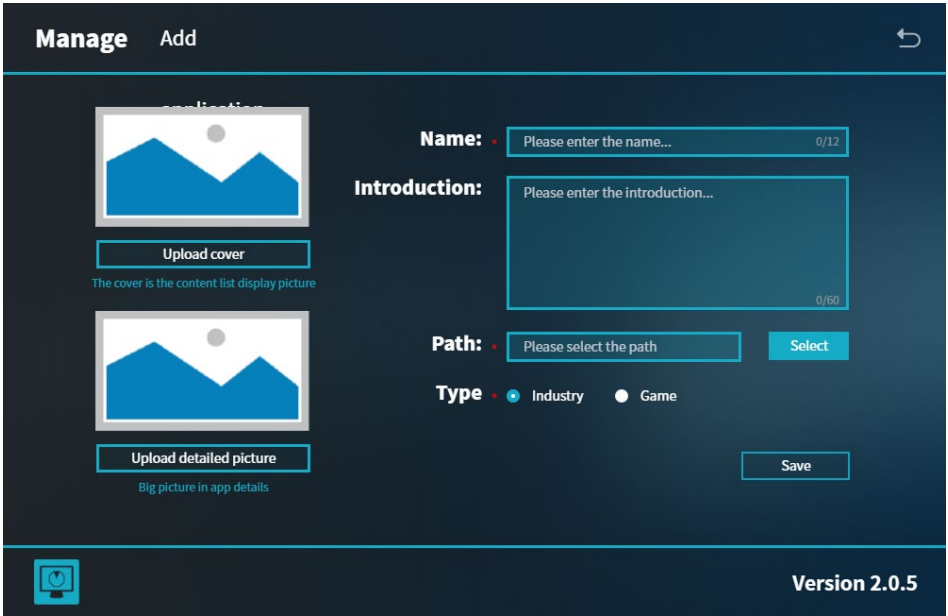

(2)

2)Upload the content cover and detailed pictures, fill in the application name, application introduction, select the root file path and application type, and click the "Save" button.
(Information marked with * symbol is required) (3)

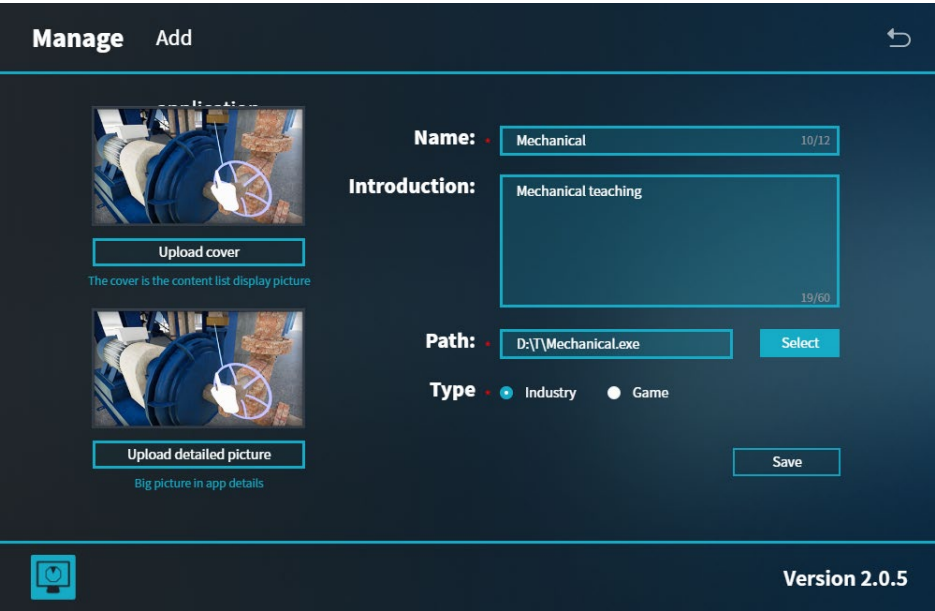

(3)

3)Deleting Content

To delete a content application, move the cursor onto the app image and click the bin icon that appears in the top right corner. (4)

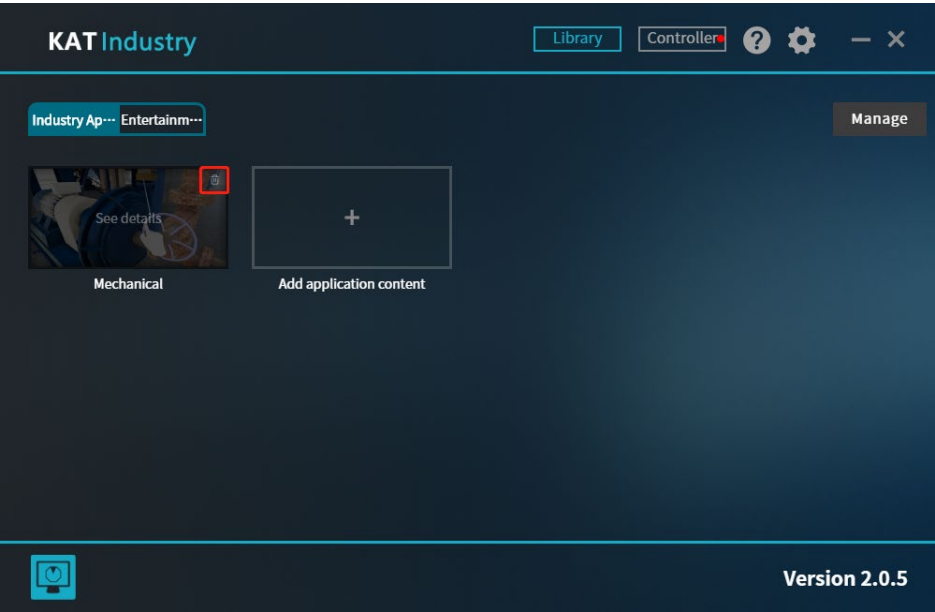

(4)

Library Manage

To open the library management panel (5), first go to the library page and click the "Manage" button in the upper right corner (4)



(5)

1)Adding Content

To add new content from here, click "Add" in the upper right corner or "Add Application Content" button below the list. Then, follow the same steps as explained previously (6)

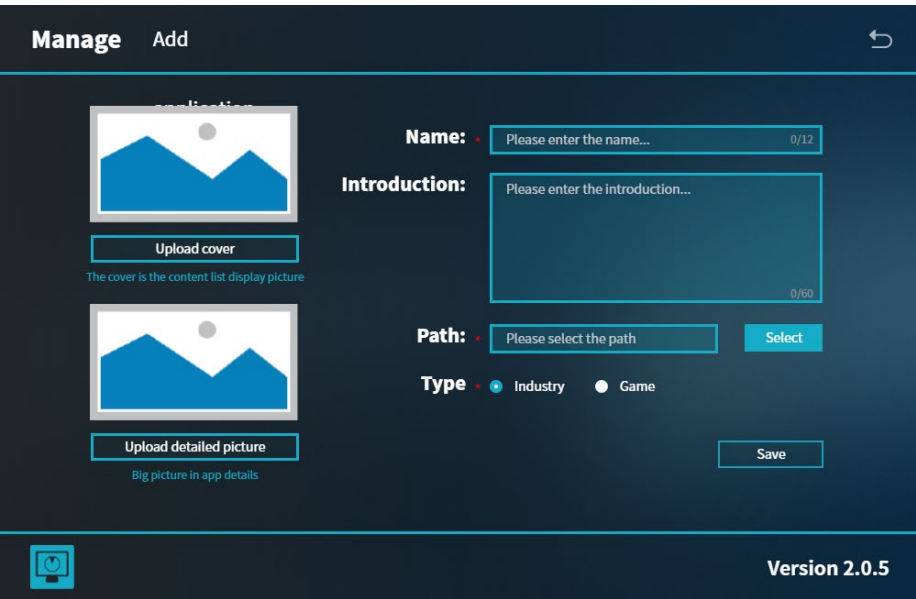

(6)

2)Editing Content

To edit the content, click the "Edit" button on its right. After changing the content information, click the "Save" button (6).

3)Deleting Content

To delete content from here, click the "Delete" button on the right (5).

Controller Dashboard

The Controller Dashboard shows the device Connection Status, Parameter Setting, Calibration button and Real-Time Data (7)

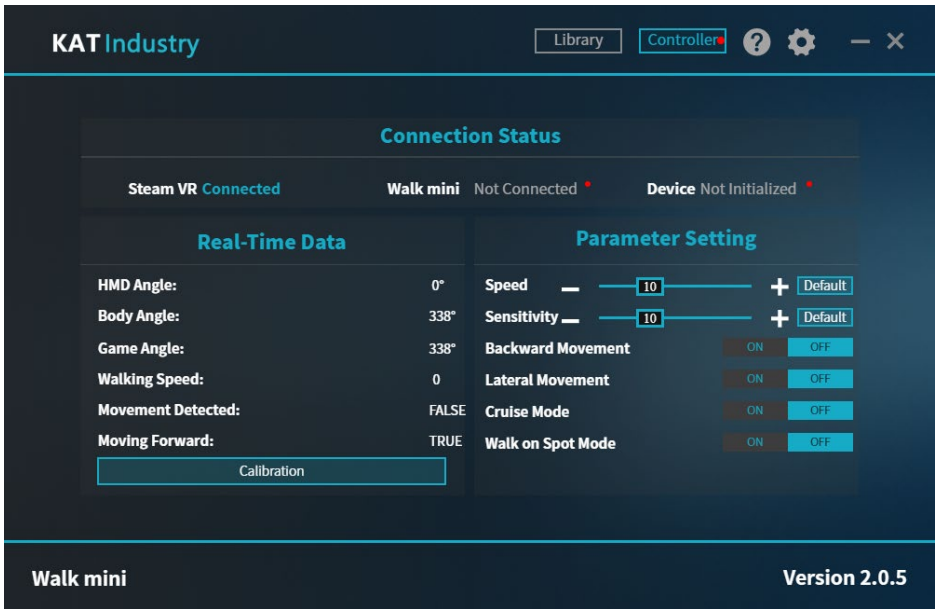

(7)

1)Connection Status (7)

Steam VR connection status informs you whether the Steam VR software is working properly .
Device connection status informs you whether the device is properly connected and ready for use.

Device initialization status informs you whether the device is already initialized.

2)Parameter Setting (7)

The parameter settings show:

Walking Speed Adjustment Slider;

Movement Trigger Sensitivity Adjustment Slider;

Special movement functions (backward, lateral, cruise, walk on spot);

Vibration Feedback Adjustment (8)



(8)

3)Calibration

Once on the device, you can calibrate the walking direction. To do it properly, stand straight with feet together and look straight, then click the calibration button (9)

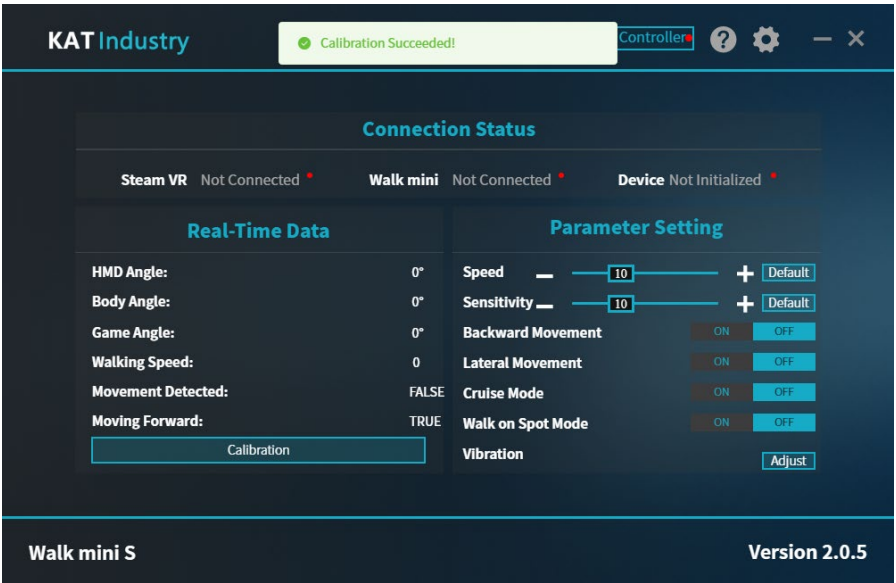

(9)

4)Real-Time Data (9)

HMD Angle: Shows the current head display angle based on Runtime.

Body Angle: Shows the current body orientation angle based on Runtime

Walking Speed: Shows the current walking speed based on Runtime

Movement Detected: Shows whether the device detects walking based on Runtime

Settings (10)

Settings include all the options as shown below with the language, software appearance and software management settings.



(10)

Starting the applications

To start the application, click the application picture to enter the Application Details Page (11)

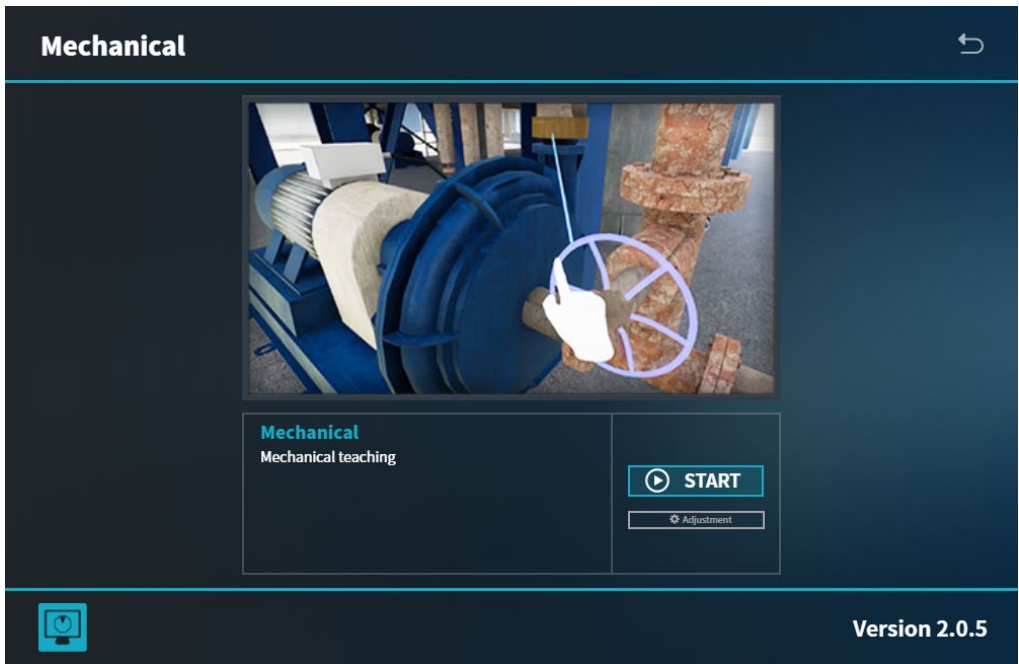

(11)

Then, click the "Start" button. The application will now either start, or if there are any connection errors of the device, HMD or SteamVR, a pop-up window will appear.

If the application has been started but the experience is not normal, refer to the instructions below:

After successful start, in the top right corner you will see a timing window, which also displays the calibration and settings buttons (12).

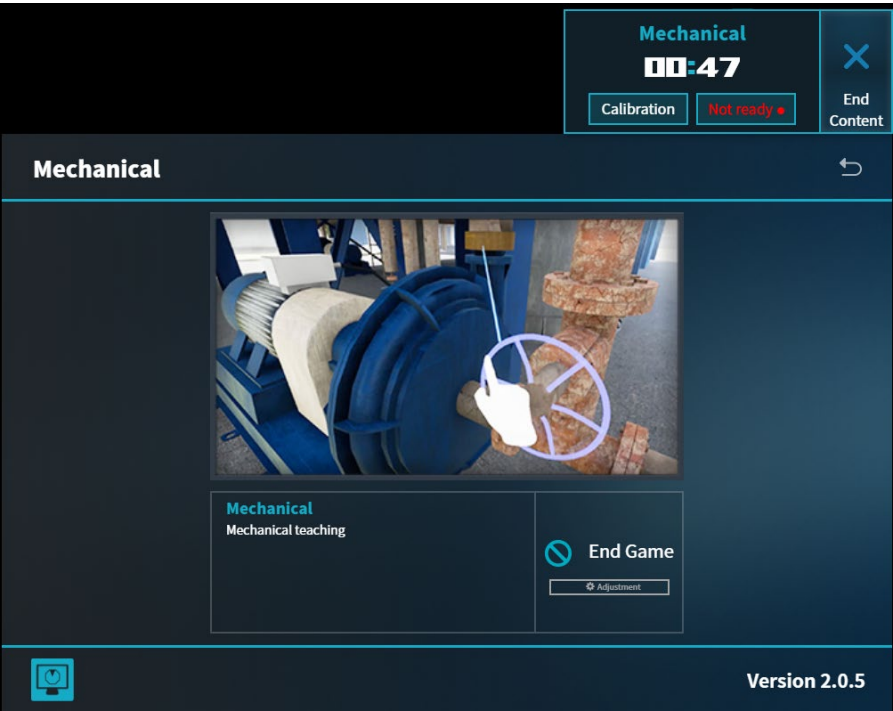

(12)

Click the "Calibration" button to calibrate the walking direction.
Click the "Settings and Adjustments" / " Device Not Ready" button to set the controller parameters.

Closing the Application

To close the application, click the "End Application" button in the top right corner (13).

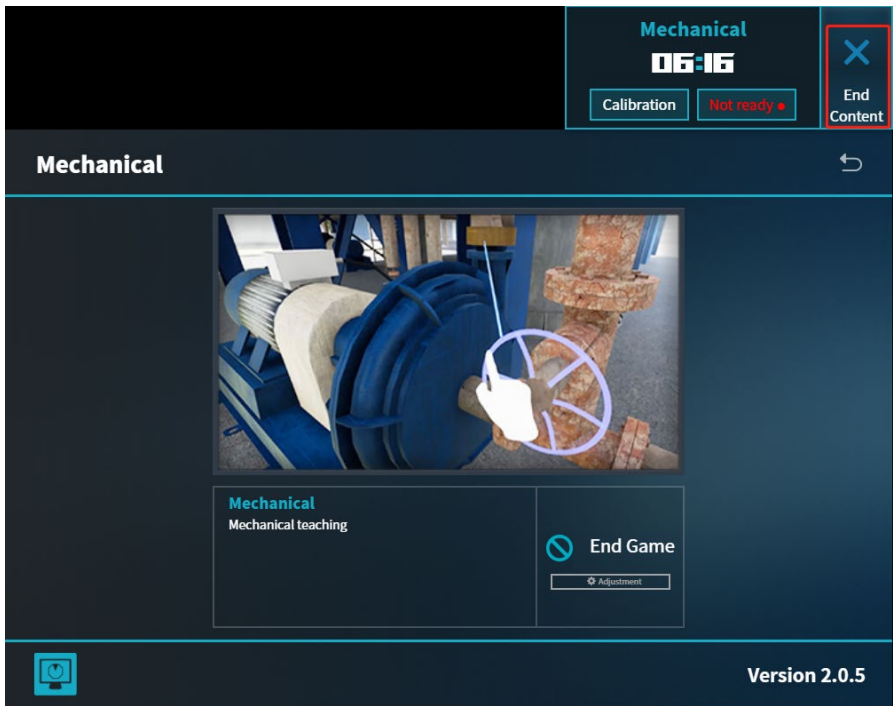

(13)

Direction calibration within VR

If directional deviation occurs when experiencing content in VR, the device user can access the calibration panel from within VR.

- 1.Click the menu button of the controller to enter the Steam VR menu;
- 2.Click the icon of KAT Industry application software (named Industry) in the lower left corner to enter the calibration page
- 3.Click "Direction Calibration". (14)



(14)

Updating the Mini S Industry Application Software

After receiving the newest version of the program provided by KAT VR after-sales service personnel, start installation as below (15).

The version number shown below is an example:

KAT_Industry Setup 2.0.2.exe

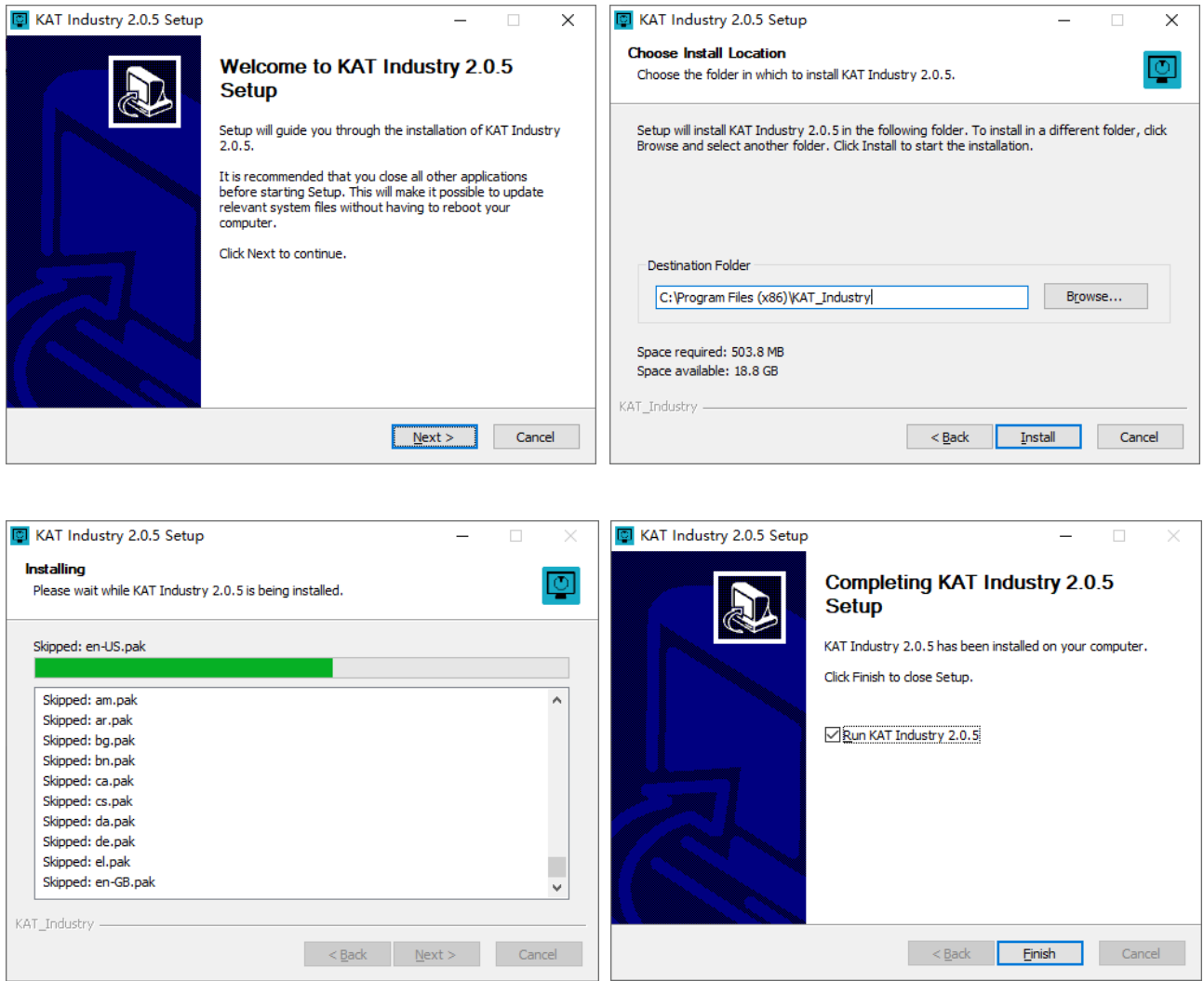

(15)

| First Use Instructions

Sensor Instructions

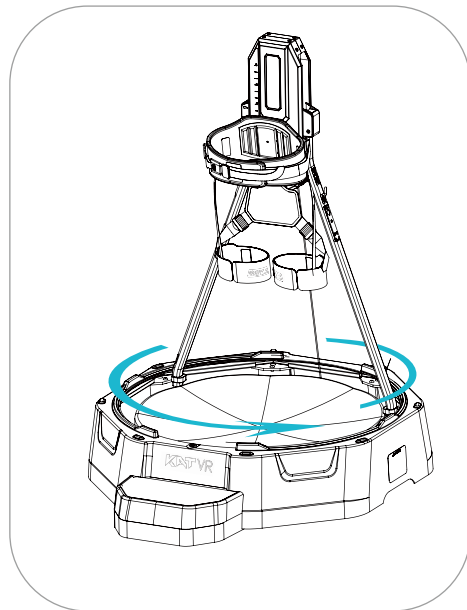

Sensor Initialization

Every time after powering on the device, initialize the inner sensor by rotating the upper structure once.

Tips for Room Settings of the VR Headset

 The following instructions refer to HTC VIVE but are applicable to other SteamVR headsets as well.

Please note that the treadmill height adds 18.6cm to your standing level. Thus, the VR ground level should be set once you're standing on the device and it has to align with the height level of the walking platform.

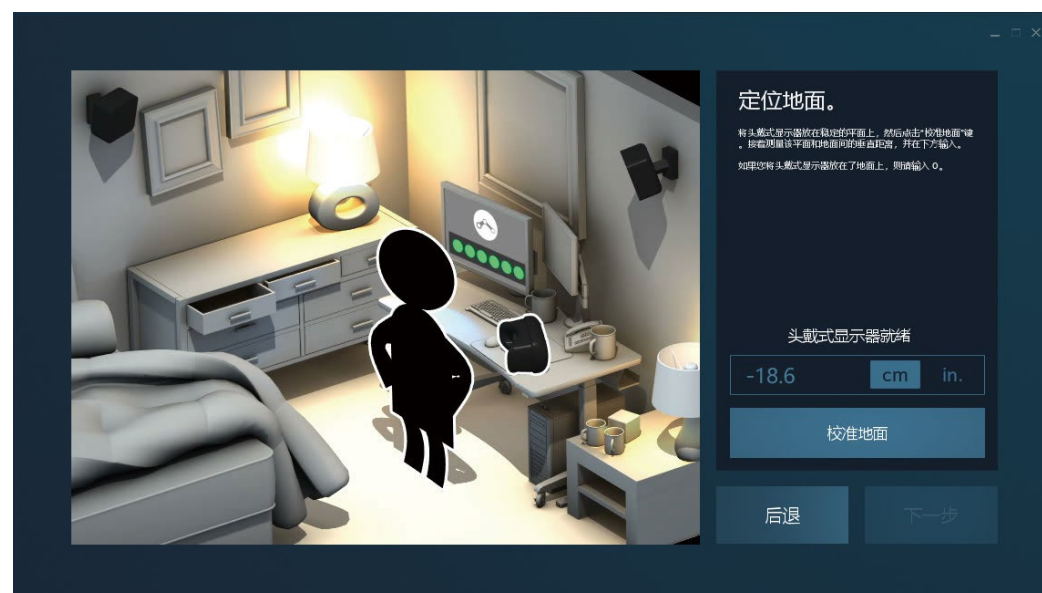

Sensor Calibration

If any of the situations below occurred before using the Walk mini S, the orientation of the sensor should be calibrated in order to correctly map your physical actions into the VR game or simulation.

- Just installed or moved the Walk mini S.
- Moved the VR headset's base station (if any).
- Re-doing the room settings for your VR headset.

Before sensor calibration, please make sure that the room setting for your VR headset has been completed correctly and the sensor initialization operation has been performed.

Now onto the calibration process:

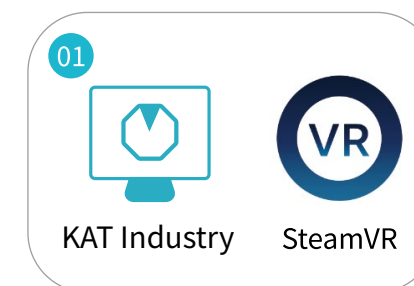

Enter the KAT Industry and SteamVR

- 02 Lock the rotational safety mechanism of the device.

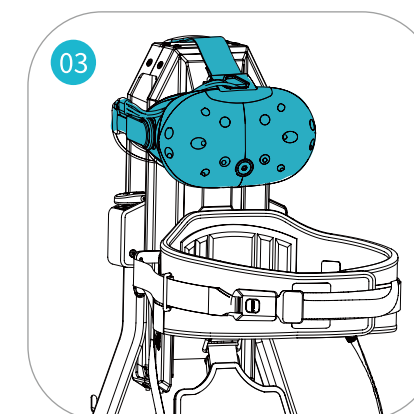

Place your VR headset on the back support plate facing exactly the same direction as the plate itself.

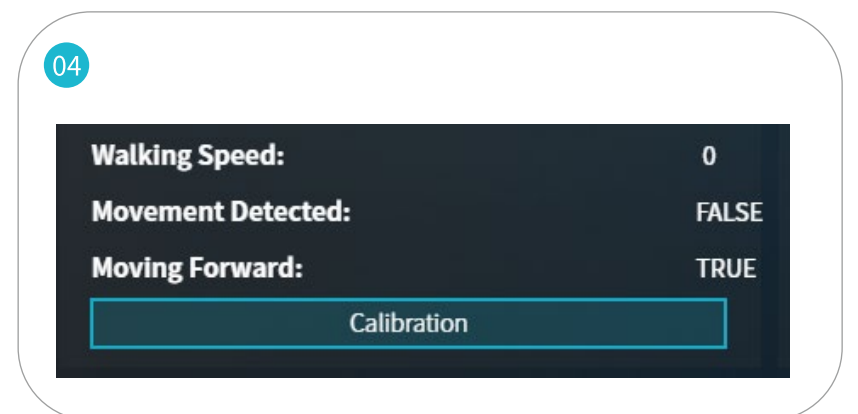

Click the "Calibration" button to complete the process.

| Walk mini S Operating Instructions

Walk mini S Quick Operating Instructions -- ONLY 3 Steps to go

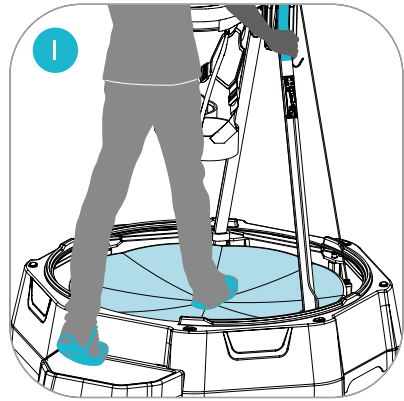

STEP 1 Stepping on

Put on the shoe covers and get onto the safety step. Grab the supporting rods for stability and enter the center of the walking platform.

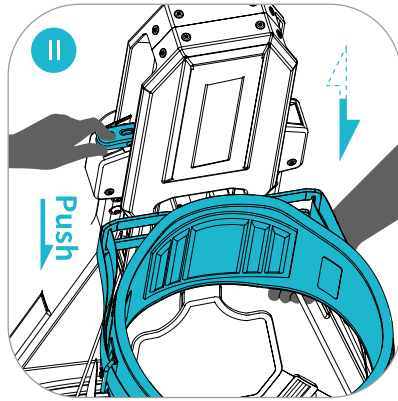

STEP 2 Height Adjustment

Adjust the height of the back support plate by pulling it up or pushing it down with one hand pressing the height adjuster.

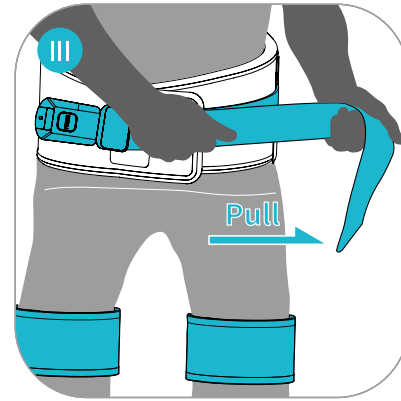

STEP 3 Harness Wearing

Tightly fasten the harness safety belts and buckle up. Pull the buckle adjusting belt to reassure the harness sits firmly on your waist.

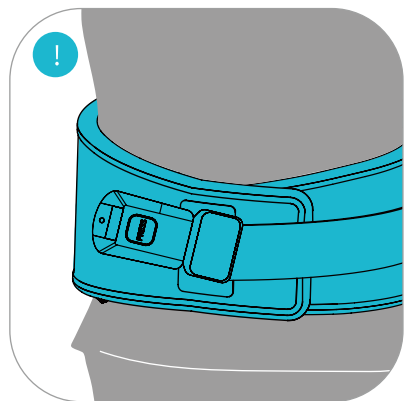

Make absolutely sure the harness is fastened tightly. Loose belts will affect both the safety and the quality of your VR experience.

Walk mini S First Use

Stepping On

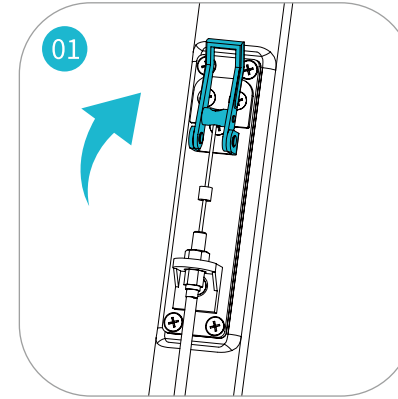

Unlock the rotational safety mechanism.

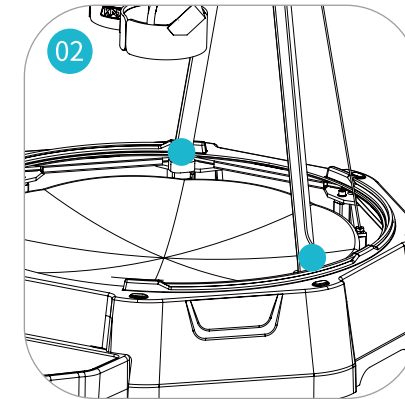

Rotate the supporting rods to the position shown above.

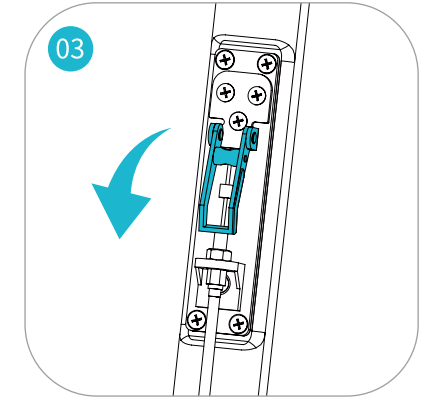

Lock the rotational safety mechanism.



Put on the special shoe covers.



Fit your heel into the special shoe covers then fasten the buckle.

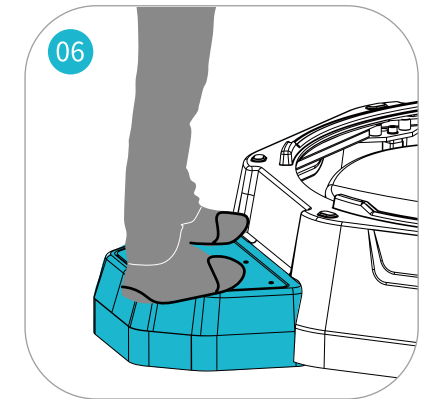

Step onto the safety step.



Grab the supporting rod as indicated by the sticker.

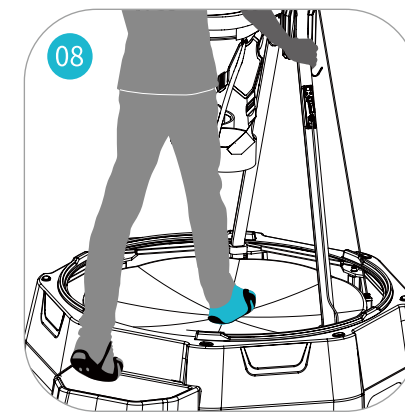

Enter the center of the walking platform.

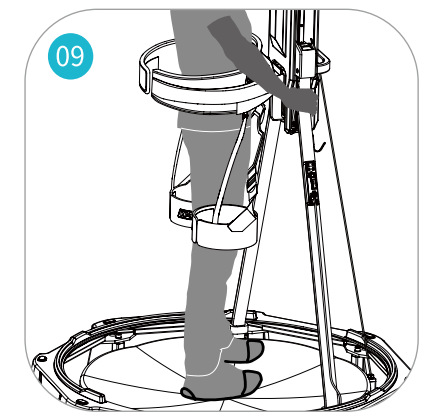

Stand facing the back support.

Height Adjustment

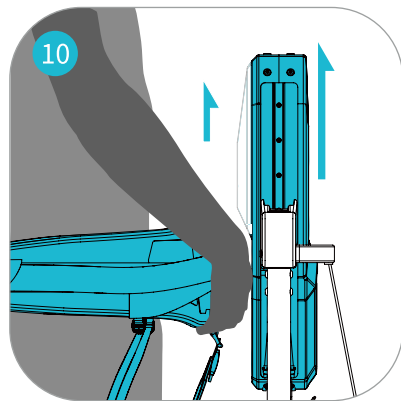

Lift the back of the harness, adjust it to a comfortable position on your waist and then slightly press it down to fix.

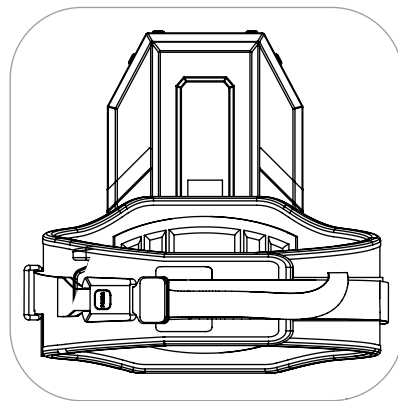

This is the highest possible position.

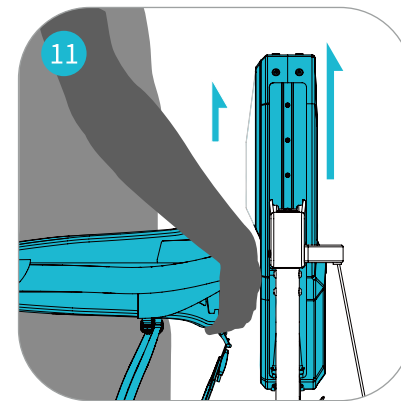

For lowering, slightly lift up the harness with both hands.

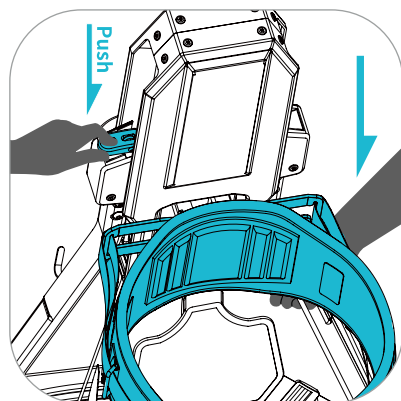

Then press the height adjuster with one hand letting the back support slide down to the intended position.

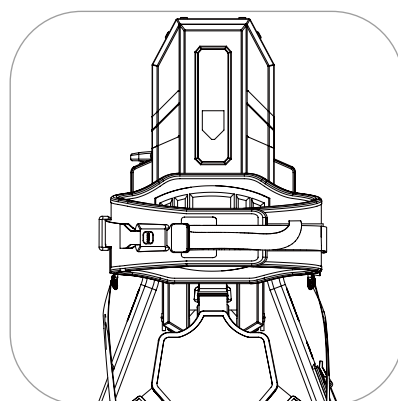

This is the lowest possible position.

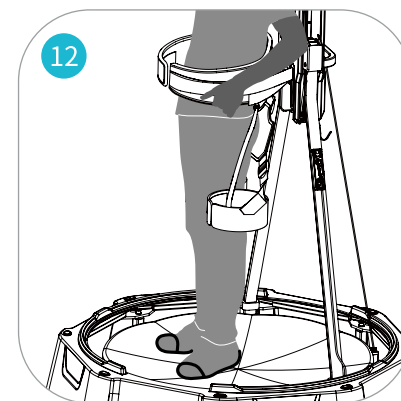

Turn forward to prepare to wear the harness.

Harness Wearing

i This procedure is crucial! Improperly fastened harness will affect your walking experience!

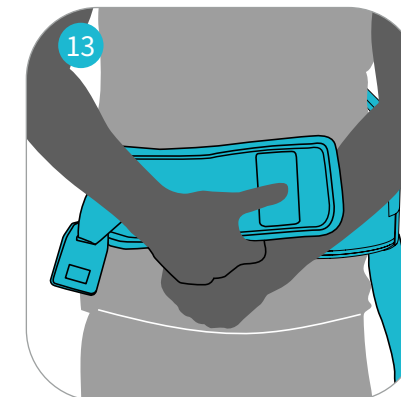

Lean closely against the inner side of the harness and pull both sides of the strap, closing the ring around the thinnest part of your waist (make sure both sides connect above your crotch). Then, stick the velcro as tight as you can to ensure there is no space left.

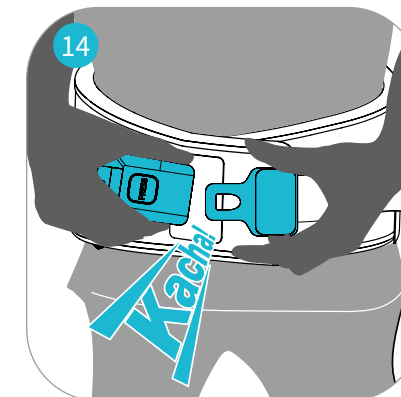

Buckle up the harness for safety.

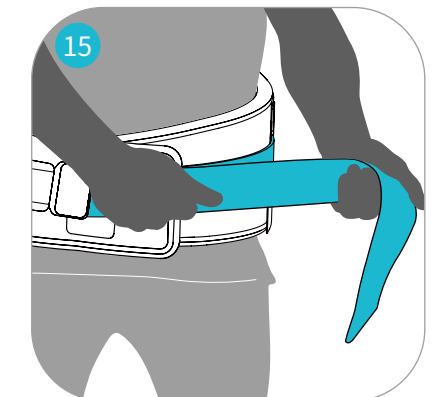

To tighten the harness, pull the left side of the strap with both hands until the adjustable belt is to the tightest. Meanwhile, fit your waist to the strap.

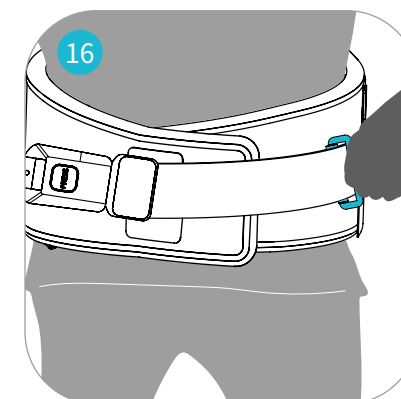

Pull the clasp belt, tightening it until reach the tightest comfortable position, and fasten the remaining part of the belt.

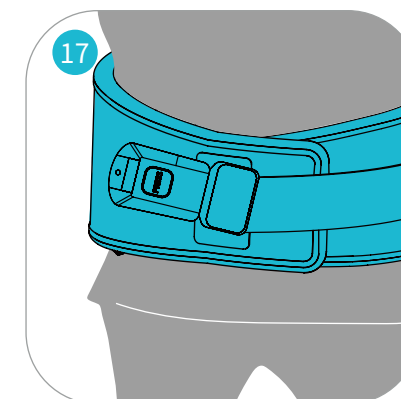

Reconfirm the harness and adjustable belt to be tight enough so that there is no space left between your waist and the harness.

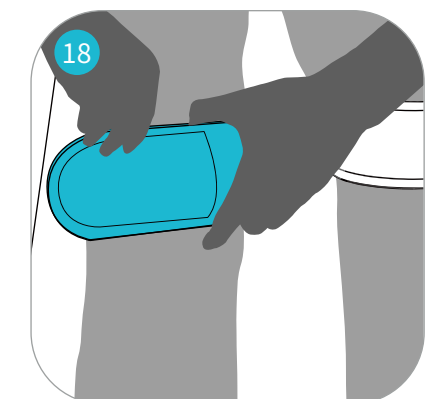

As to the leg straps, tighten the velcro around your thigh, ensuring there is no space left.



when you don't need leg straps, please hang them to the supporting rods or simply undo them, otherwise the hanging part may become the signal interference.

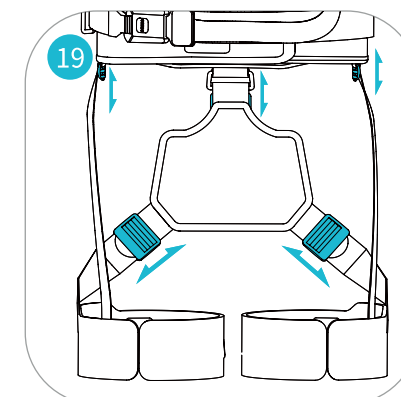

Take advantage of the adjustable buckles behind and use them to adjust the length between the leg straps and seat to your comfortable position.

Height Adjustment

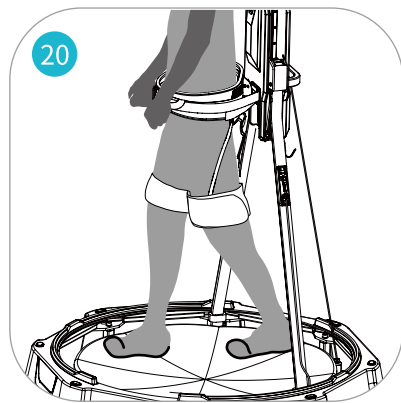

Once strapped yourself in securely, try to step forward.



Try to sit down.



Try to crouch. (If you encounter jamming of the back-support device when trying to squat, please reduce the depth of squat or adjust your squatting position vertically to solve the problem.)

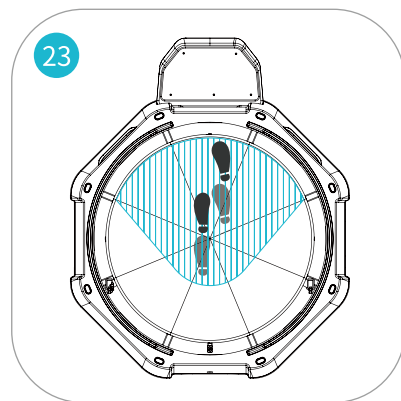

To advance with the in-game character, keep shifting your steps back and forth.

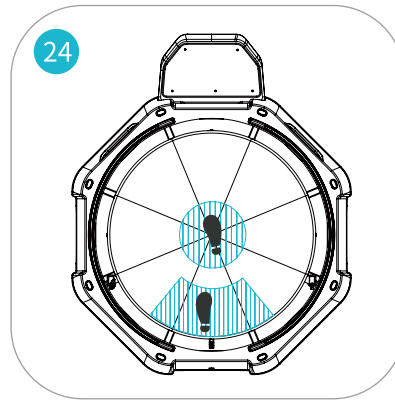

To keep retreating with the in-game character, firmly stand with one foot in the centre and take one step back with the other.

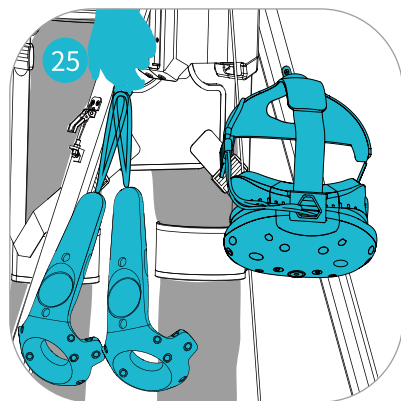

Hang your VR headset and controller on the hooks behind the back support for easy access while on the device.

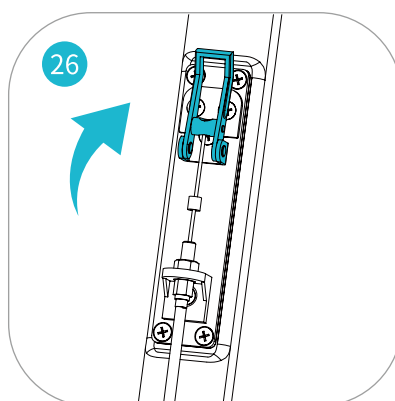

Unlock the rotational safety mechanism



Game on.

Stepping Off

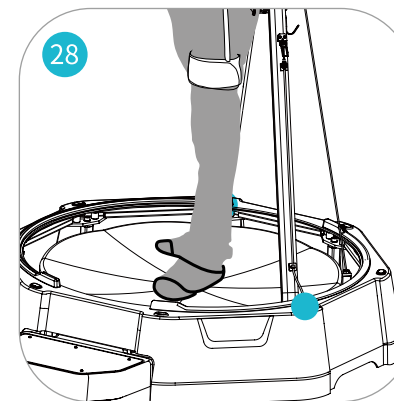

Rotate the supporting rods to the position shown above.

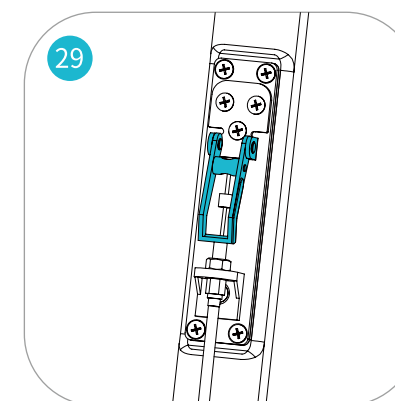

Lock the rotational safety mechanism

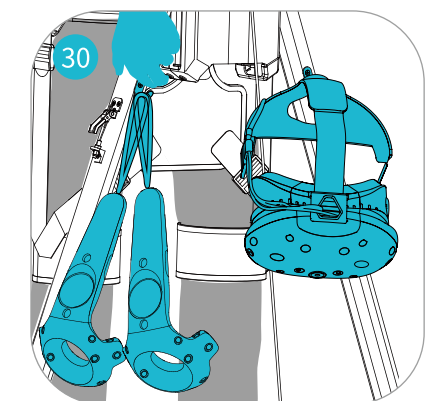

After removing your VR headset and controllers, you can hang them safely behind by the hook.

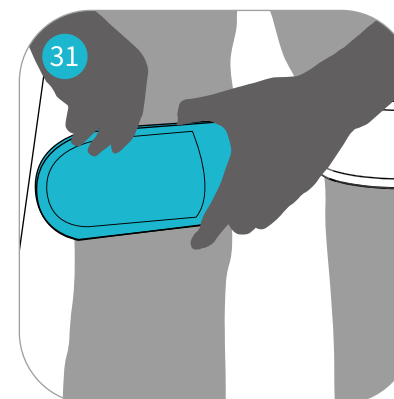

Undo the leg straps.

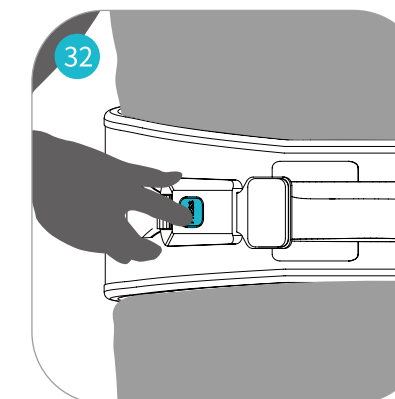

Unfasten the buckle on the harness.



With one hand holding where the sticker indicates, gently step off onto the safety step.

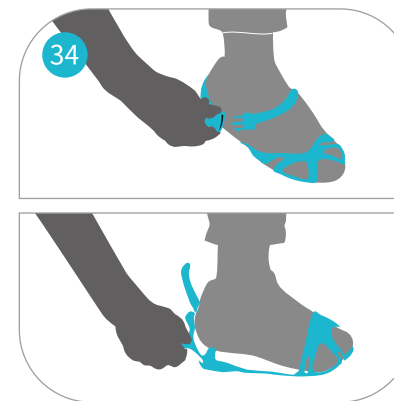

Take off the special shoe covers.

| Software Instructions

System Requirements

- Operating system: Windows 10.
- USB port: 3 x USB 3.0 or above
- Storage space: 400 MB free hard disk space (for installing the software)
- Software support: SteamVR (Steam official website: <http://store.steampowered.com/>)

 For other system requirements, please refer to instructions of your particular VR headset.

Software Instructions

01 Introduction to KAT Industry Software

KAT Industry is a product management software tool developed by KAT VR for business users. It lets you control the device and access the settings without leaving the virtual world. Additionally, you'll be able to access all the supported content in one place. When using SteamVR content, KAT I/O in-VR dashboard will also guide you to the proper settings without accessing a remote PC.

 If you are accidentally blocked by your computer's firewall during the process of installing or running KAT Industry, please allow the software to operate and add trust to KAT Industry in the firewall Settings to avoid affecting the normal use of the device



| Disassembly and Maintenance

Disassembly Procedure

If you need to move the Walk mini S, strictly follow the product's assembly instructions in the reverse order. Disassemble with caution to keep the main components intact. After dismantling the device, gently place it in its original box and use similar material to package it. Use sufficient manpower or a good logistics company to handle with care, otherwise the product may be prone to damage.

Product Maintenance



- Before daily use, always wipe the base frame's surface to rid it of dust and dirt that could abrade the surface.
- Routinely check the screws and bolts to ensure they are firmly tightened, parts that are prone to wear and tear for timely replacement e.g., the waist and leg straps. In case of necessary component/part replacement, contact customer service to get help.

-  Do not use potent detergents or any abrasive liquids to wipe down the surface for maintenance. The surface should be dry before using the device.
-  It is forbidden to pour liquids on the shell of the device so as to avoid damage to its electronic components or cause a safety hazard.

Appendix 1: Optional Accessories List

For a better experience, we also offer a variety of accessories that you can choose to match.

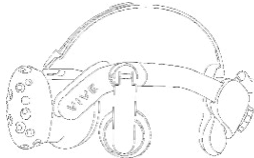
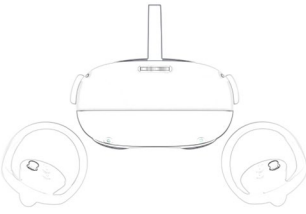
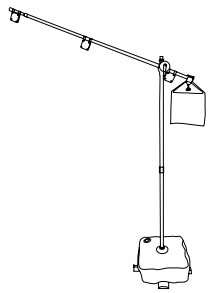
Optional Accessories List

Name	Quantity	Appearance	Note	
VR Headset: Option 1	1	HTC VIVE PRO set 	For more information, please visit the Official Website of HTC Vive	
VR Headset: Option 2	1	Pico Neo 3 set 	For more information, please visit the Official Website of Pico	
Cord bracket	1		1 set includes 2 bags	
Wire Pulley	2		Each set includes a pulley and a screw-hook	

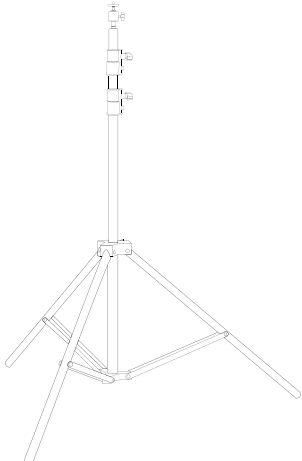
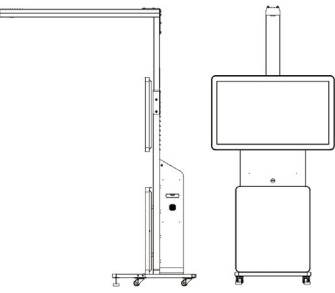
Optional Accessories List			
Name	Quantity	Appearance	Note
Base stand	2		1 set includes two stands
KAT Control Center	1 Device	 (Deluxe Control Center as the example)	Deluxe Control Center

Appendix 2: KAT Control Center

Deluxe KAT Control Center

Product Introduction

Deluxe version of the KAT Control Center which integrates: High-Resolution, LCD Touch-Screen Display, High-performance PC, 2-in1 Software Platform – Business Management System, and a 3D Surround Sound Stereo System. The device is an all-in-one solution aimed to provide easy access, maintenance, and management of the KAT VR equipment while ensuring the best quality audio-visual experience.

Product Appearance

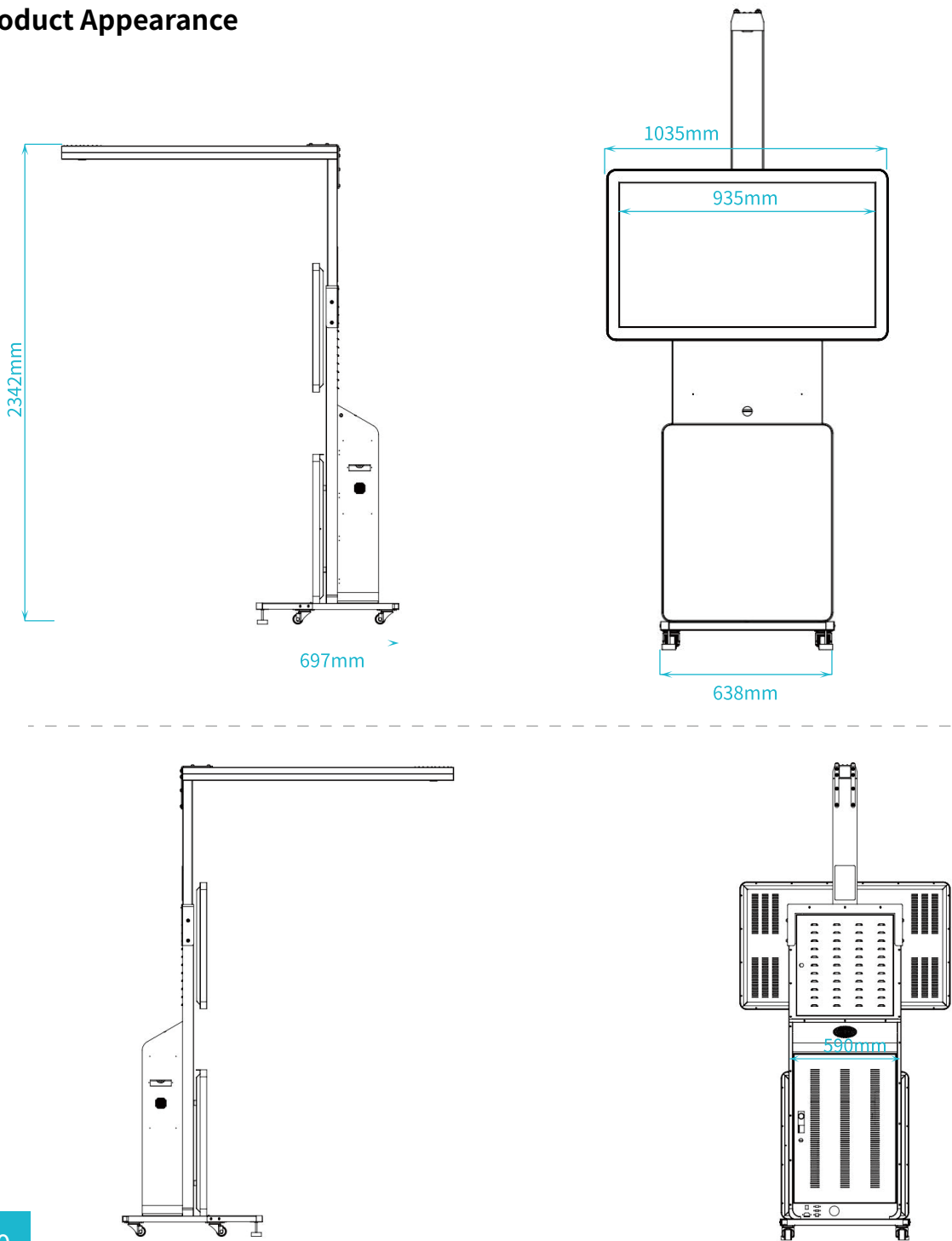

Installation of the Cable Management Beam

*There is no need to install the cable management beam if you use a wireless headset.

Product packaging

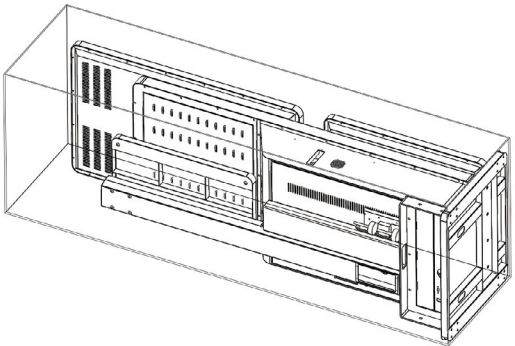

Item List

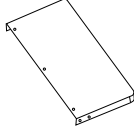
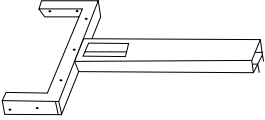
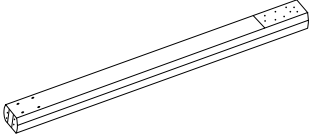
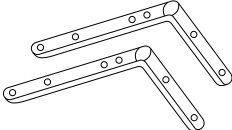
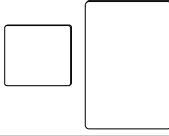
List of items			
Main Device	Control Center	1	
Cable Management Beam	Anti-tipping support	1	
	Bearing	1	
	Beam	1	
	Fittings	2	
	Magnets	2	
	Securing seat with tie	3	
	Cable Tie	6	
	Screw M4*20	10	
	Screw M5*20	6	
	Screw M8*20	18	
	Gasket8mm	18	

Installation steps

1. Take off the packing box cover and take out the components
2. Place the crate upright and take out the control center

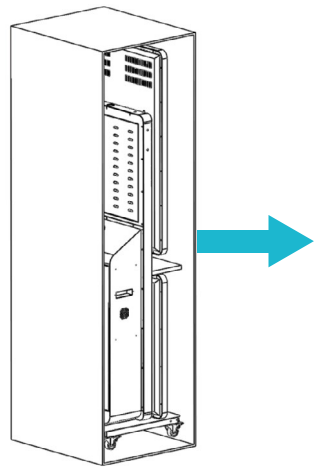

3. Install the anti-tipping support in front of the device and fix well with screws (M4*20_3) on both sides.

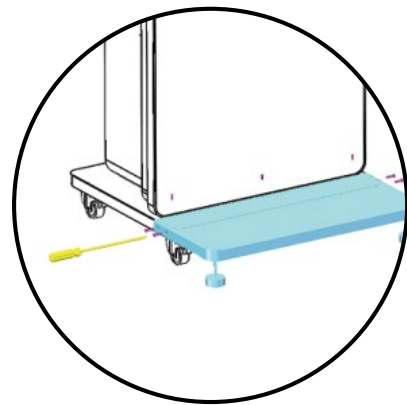
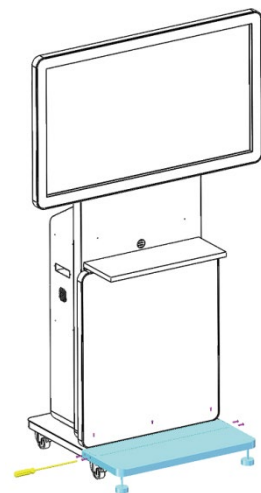

4. Remove the screws from the top sealing plate of the beam and open it.

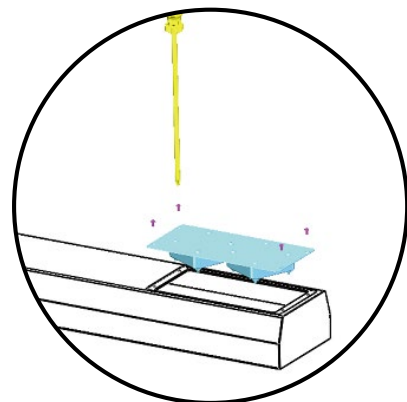
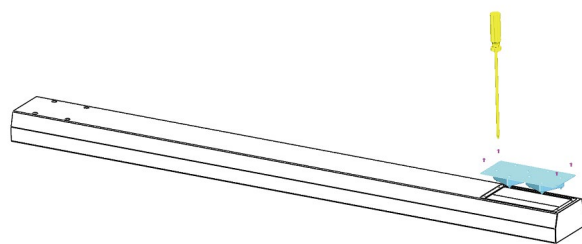

5. Using the connector, install the beam on the support and fix it well with screws (M8*20)

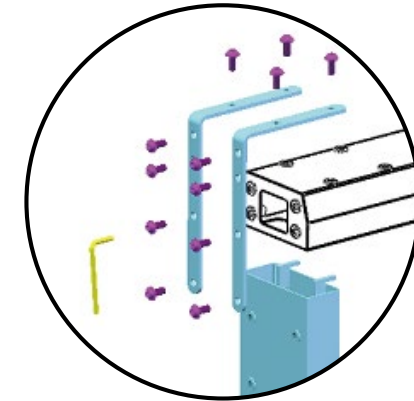
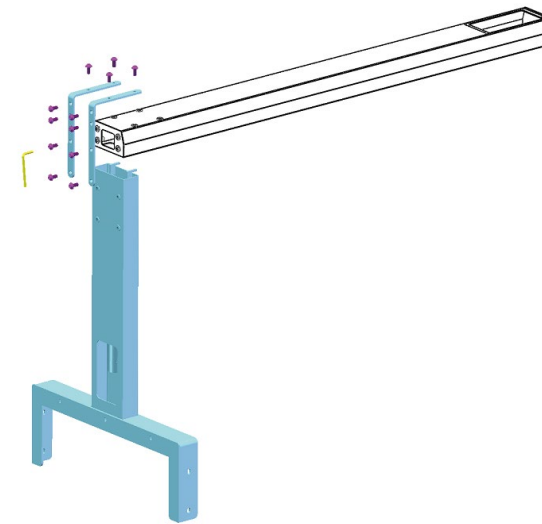

6. Remove the screws on the Control Center's top back plate.

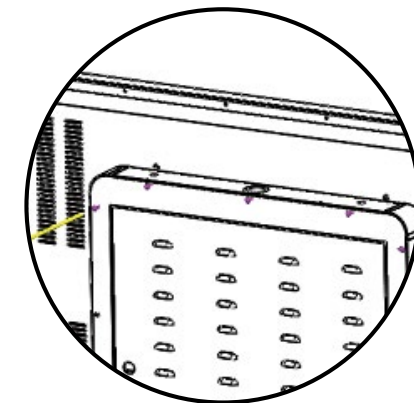
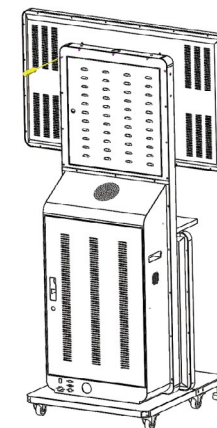

7. Place the support structure on the top back plate and fix well with 5 M4*20 screws in the front and 4 M8*20 screws with gaskets at the side.

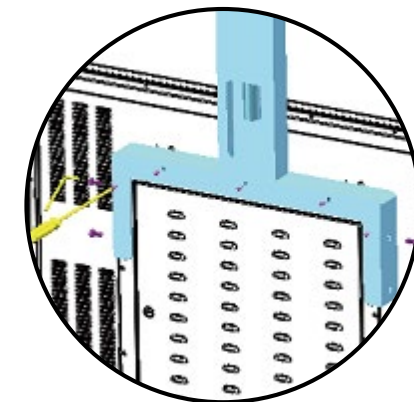
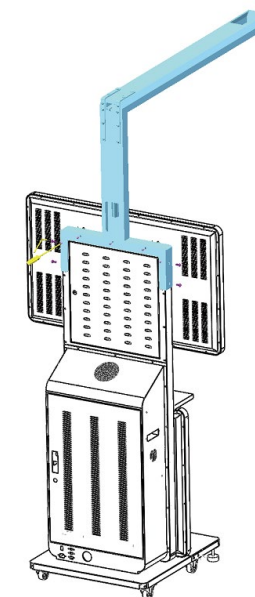

8. Once the Control Center is moved to the intended area of use, turn the supporting feet clockwise to sit them on the ground.

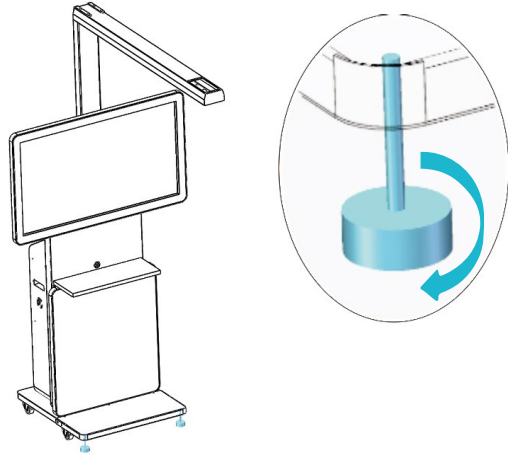

9. Insert the HMD cable into the supporting beam's round opening and push inch by inch into the pipe until it comes out from the other side.

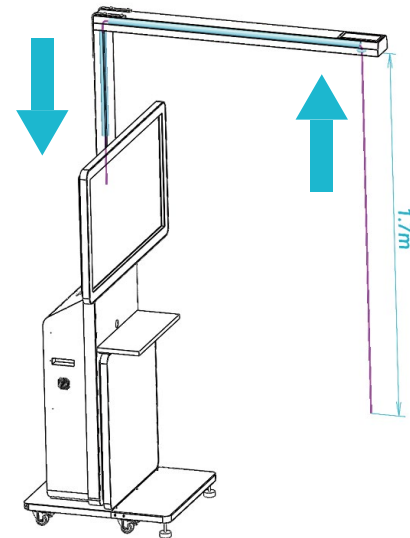

10. Connect the HMD cable to the stream box, and then to the host computer as below

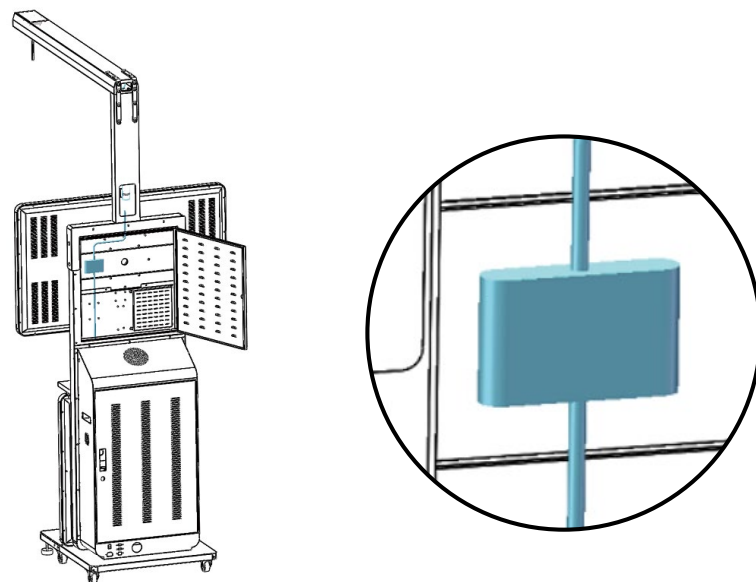

11. Once the HMD cable is inserted into the beam, place the seal plate back on the structure and fix it well with screws.

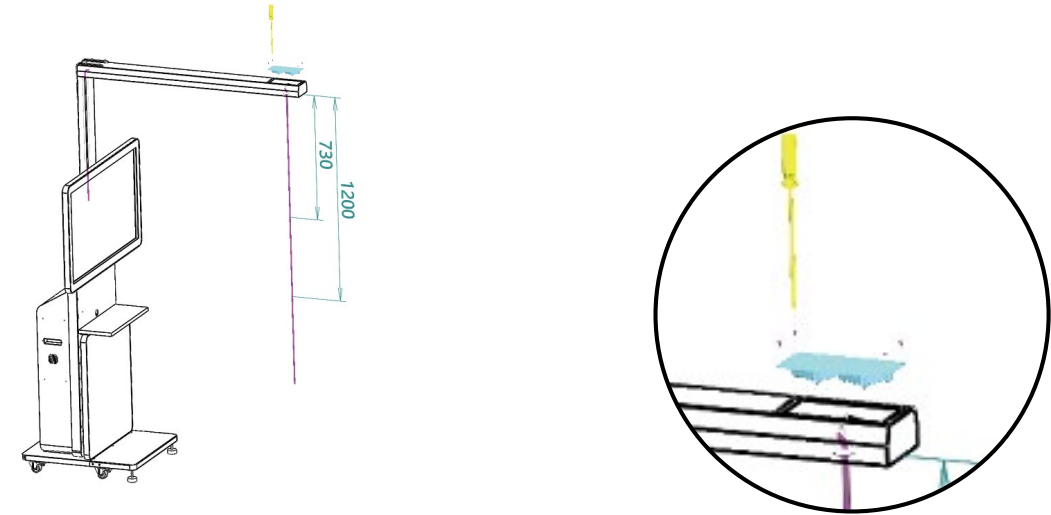

12. Use tiles to cover the openings at the back of the device.

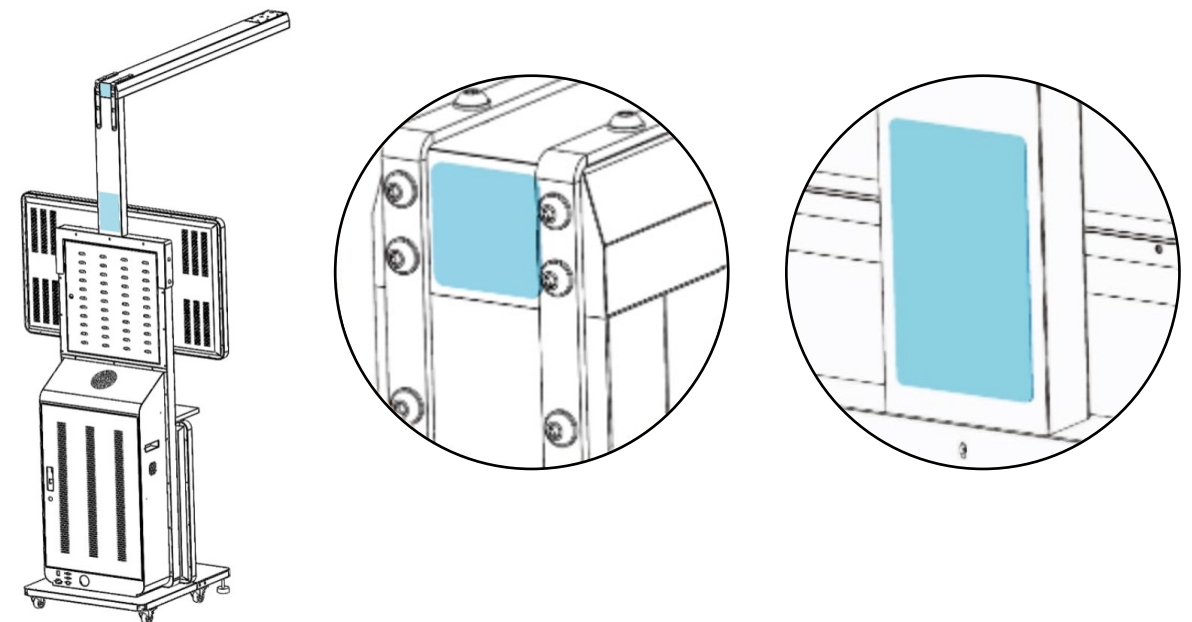

Software content

	List of contents
Operating System	You should first purchase an activation code of the Windows 10 Business Edition and install it on the device.
Installed Software	3DM Game Runtime Collection Package
	Steam Platform Client
	Steam VR
	KAT Industry Software (Contact us for more information)
	Bandzip (compression software)
	Product Instruction Files

Product's maintenance and repairs

- The equipment should not be placed in a dust-abundant environment (such as near neighborhood of the roadside window)
- Do not unplug the device from the power source when it is powered on. Switch off the interface frequently (except for the USB interface) to avoid the interface card from getting burned or damaged.
- The device must be protected from dust and liquids.
- Frequent use of hard disks, virus infection or even accidental misoperation may easily cause important data loss. Remember about regular backups.
- Should you find any problems with the equipment, do not postpone the necessary repairs for later. All damage and malfunctions must be reported and repaired as soon as possible in order to ensure that the device is always kept in a good working state.
- Install relevant anti-virus software, update it regularly and frequently scan your system in order to keep the device malware-free.

Frequently Asked Questions (FAQ)

- Q

In-game directions are deviated on Walk mini S. What should I do?
- A

Deviation problem might have occurred due to a number of reasons. Please follow the instructions below to identify, and solve the issue:

 - 1) KAT Industry platform allows its users to perform a quick, manual calibration within VR. Just click at the APP button on your controller, and select the calibration option.
 - 2) Does the initialization process occur at startup? If not, please re-plug the device's USB connections, and try initializing it again.
 - 3) Before the first use (or if you have recently relocated the device), please complete the room setup, and directional calibration process.
 - 4) When not in use, the leg straps might cause a minor interference. In order to solve this issue, simply attach the straps to the corresponding support rods to prevent them from swinging.
 - 5) Please adjust the safety harness to your body, and tighten it up to avoid any loose space between your back, and the back support.
- Q

It is not possible to move, or the motion is too slow on Walk mini S. What should I do?
- A

Inability to walk or unnaturally slow motion might have occurred due to the following reasons:

 - 1) If you are unable to move forward within games, please check if Steam VR has been initialized, and is working properly. Then, check if the connection between your headset, and controllers has been established, and is functioning correctly. Try restarting SteamVR.
 - 2) If you are unable to move within games, please check the status of Walk mini S in KAT Industry. If its parameters are abnormal, re-plug the USB wire on mini S's interface. Then, perform the initialization process, and restart SteamVR.
 - 3) If walking is not available in Steam games, please make sure the controllers have been turned on, and the game settings are correct.
 - 4) If the walking speed seems abnormal, you can manually calibrate the speed parameter in KAT Industry Runtime up to the maximum speed set for the selected game.
- Q

What should I do if the installation process of Walk mini S has been correctly accomplished but the supporting rods are not moving or are getting stuck.
- A

Please check if the rotation lock of the supporting rods has been unlocked. If the rods are still not functioning properly, adjust the corresponding screw counterclockwise.

Q LED lights on my Walk mini S are not lighting up.

- A** 1) Please check if the LED light's DC, the power adapter, and the power cord are all correctly plugged in.
- 2) Please check if the energy outlet is energized, and the power switch is turned on.

Q Till now I was able to use the keyboard and mouse without problems, until they suddenly stopped working. What should I do ?

- A** Please follow the steps below:
- (1)Please check if the keyboard lock button is enabled. In such case, please unlock the keyboard.
- (2)Please confirm that your mouse and keyboard are firmly connected to the relevant ports on the motherboard.

 If the malfunction stops at some point and the device enters its operating system as normal, we strongly recommend you to create a backup for all of your important data.

 When replacing the hard disk, please do not touch the components with your bare hands to prevent damage caused by static electricity.

Q After turning on the device, BIOS detects the CPU, memory, hard drive and keyboard normally, but the screen displays "cmos checksum error – Defaults loaded". What should I do?

- A** The common cause of this problem is that the peripheral card's resources conflict with the BIOS, causing it to reset. Press the "del" button to enter the CMOS settings, then press the F10 button, type "Y" and press Enter to restart the system.

Q The computer turns on as normal, but keeps restarting before entering the operating system desktop. What should I do?

- A** Please follow the steps below:
- (1)Please check if the status of ACPI function in the CMOS settings of the Power Management Setup is consistent with the default setup.
- (2)Please check if the operating system startup file is intact.
- (3)Please format the hard disk and reinstall the operating system.
- (4)Please try again after replacing the malfunctioning CPU.

Q The device used to work normally, but recently the software runs slower, and sometimes it even crashes. What should I do ?

- A** Please follow the steps below:
- (1)Please check if the cooling system works as normal and the CPU cooling fan rotates smoothly.
- (2)Please scan your hard disk for presence of bad sectors.
- (3)Please check if the memory module is malfunctioning.

Q The device is not functioning properly, when peripheral devices are connected. What should I do?

- A** Please follow the steps below:
- (1)Please check if the peripheral devices are firmly connected to the relevant ports.
- (2)Please check if the power supply unit is properly connected and works as normal.
- (3)Please check if the ports, which the peripheral devices are connected to are working properly.
- (4)Please check if the port configuration and electrical specifications are compatible with these of the peripheral device.
- (5)Please check if the peripheral device functions properly when connected to other computers.
- (6)Please check if the device can connect to the other peripheral devices in some other types.